

GLENLEY PRESSURE BALANCE TUB AND SHOWER SET WITH CROSS HANDLE

SKU: 909338

Code: SH204228, SH204226, SH204231



FEATURES

Installation Type: Wall Mount
Features: Pressure-Balanced; Tub Spout Included
Design: Traditional
Material: Brass
Assembly Required: No
Handle Type: Cross
Installation Type: Wall Mount
Shower Head Installation Type: Wall
Shower Head Diameter: 2-3/4"
Shower Head IPS: 1/2"
Shower Head Swivel: Yes
Valve Trim Width: 7-5/8"
Valve Trim Height: 7-5/8"
Shower Head Flow Rate: 1.8 gpm (6.8 l/min) @ 80 psi

IAPMO



REVISED 3/29/2023

GLENLEY PRESSURE BALANCE TUB AND SHOWER SET WITH CROSS HANDLE

SKU: 909338

Code: SH204228, SH204226, SH204231



ADDITIONAL FEATURES

- Cross handle control.
- Shower head measures 2-3/4" diameter.
- Shower head extends 8" from wall.
- Pressure valve trim measures 7-5/8" diameter.
- Tub spout measures 5-1/2" long.
- Tub spout GPM: 10.3 gpm (38.99 l/min) @ 80 psi.
- Shower head GPM: 1.8 gpm (6.8 l/min) @ 80 psi.

REVISED 3/29/2023

GLENLEY PRESSURE BALANCE SHOWER VALVE

SKU: 909338

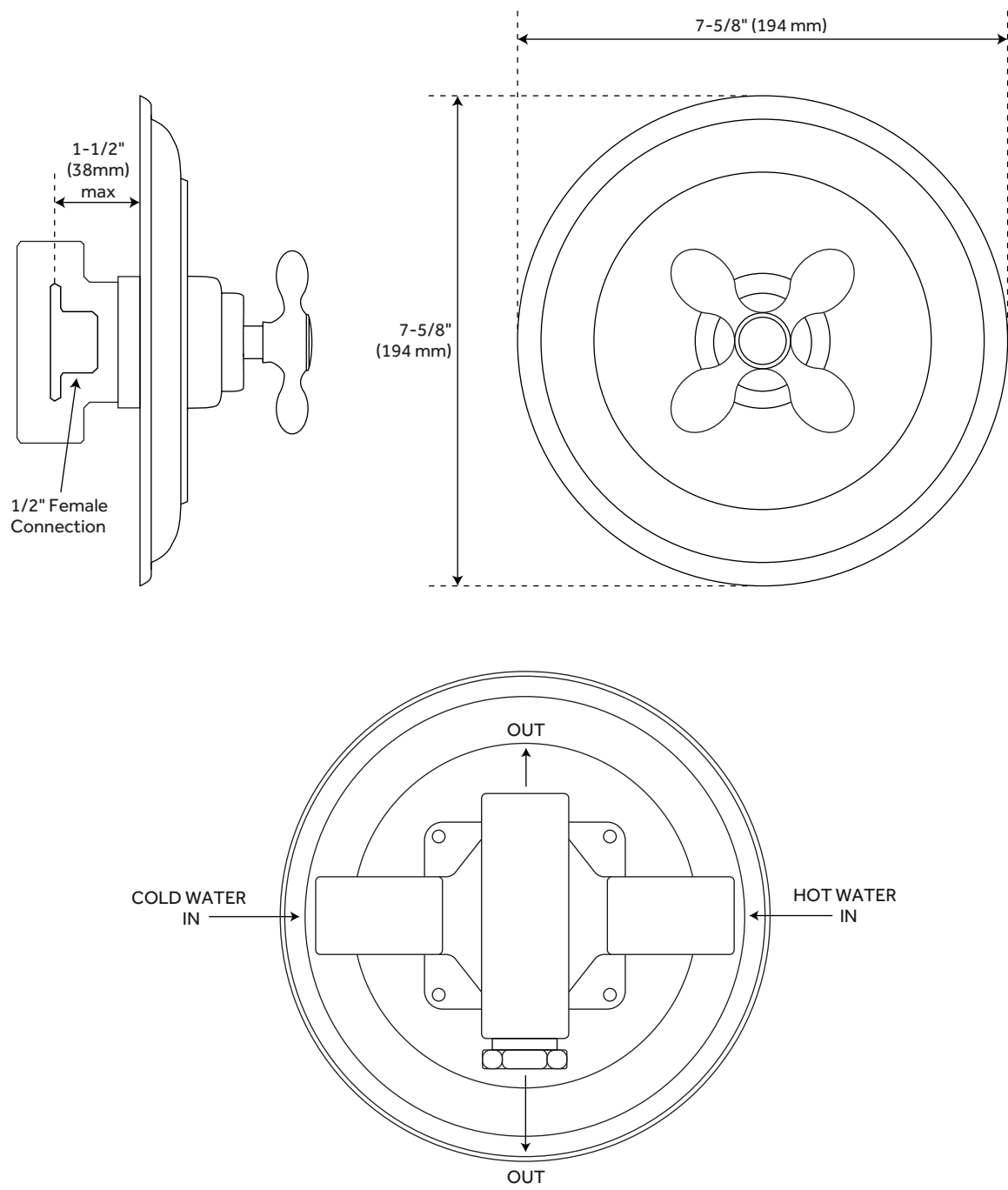

All dimensions and specifications are nominal and may vary. Use actual products for accuracy in critical situations.

GLENLEY WALL-MOUNT SHOWER HEAD

SKU: 909338

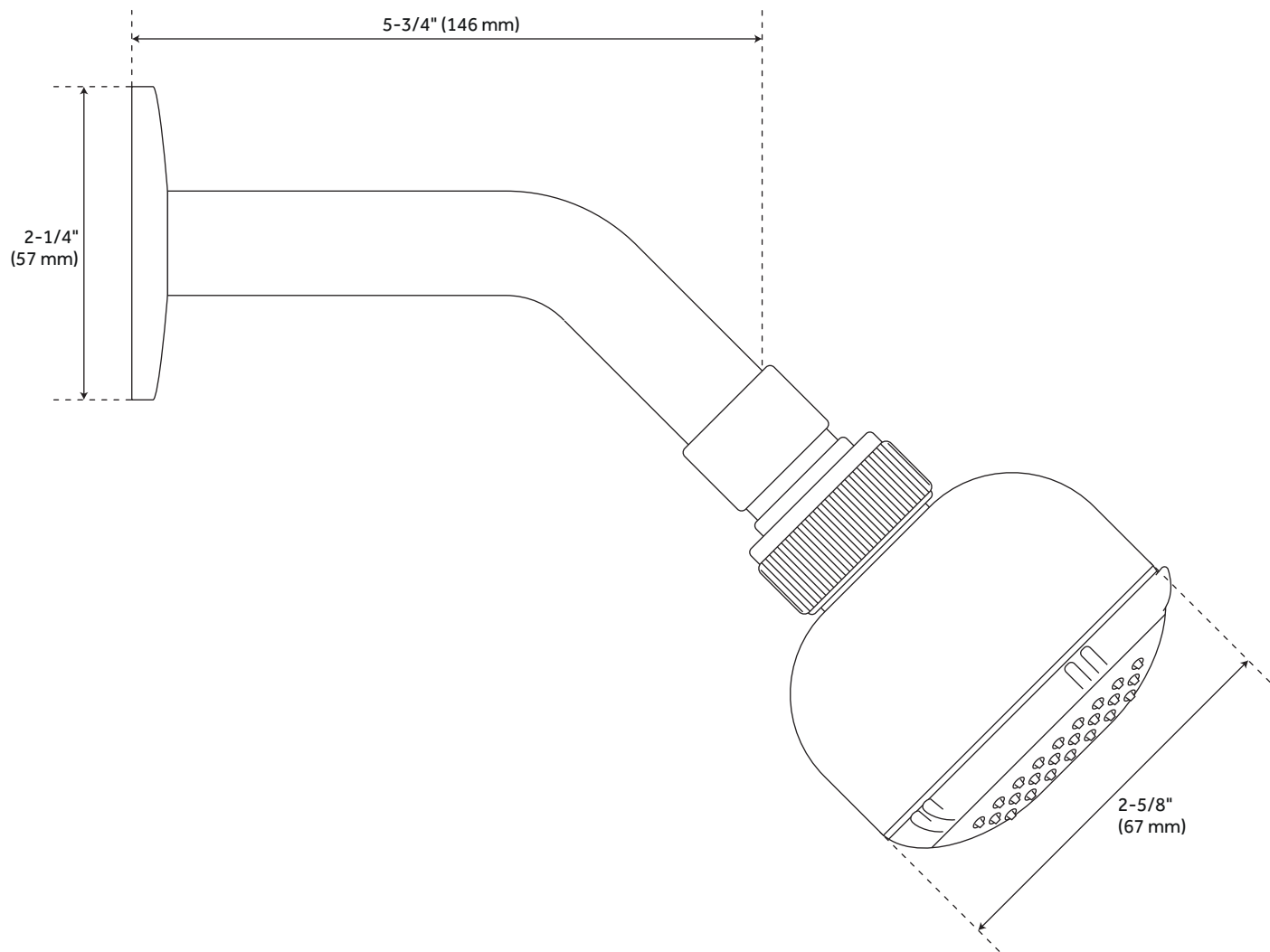

All dimensions and specifications are nominal and may vary. Use actual products for accuracy in critical situations.

GLENLEY TUB SPOUT

SKU: 909338

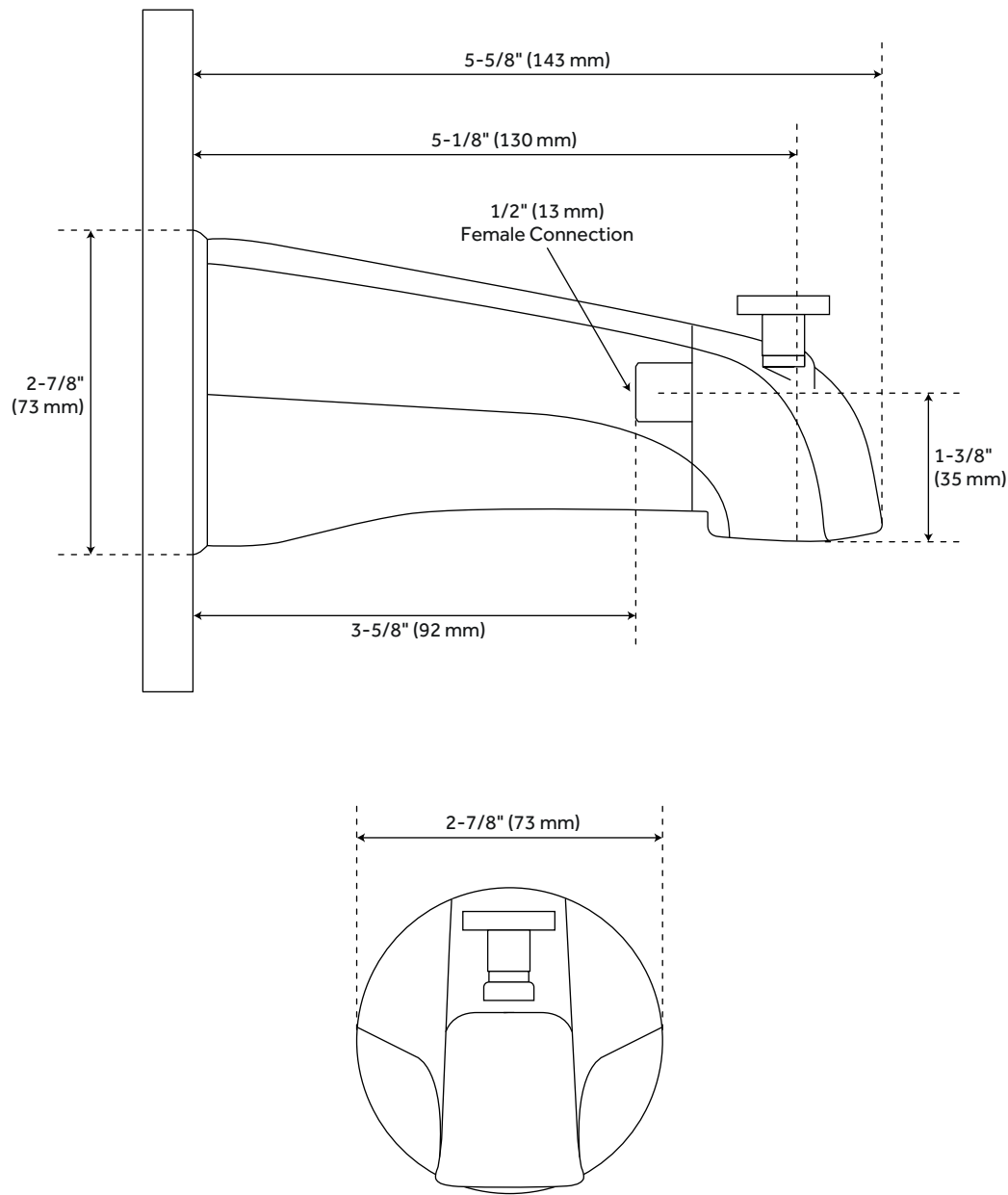

All dimensions and specifications are nominal and may vary. Use actual products for accuracy in critical situations.