



SKU(s): 934430

RYLE THERMOSTATIC SHOWER SET INSTALLATION

BEFORE YOU BEGIN

We recommend consulting a professional if you are unfamiliar with installing plumbing fixtures. Signature Hardware accepts no liability for any damage to the plumbing, floor, walls, tub, or for personal injury during installation.

Observe all local plumbing and building codes.

Unpack and inspect the items for shipping damage. If any damage is found, contact our Customer Relations team at 1-866-855-2284.

GETTING STARTED

- Ensure that you have gathered all the required materials that are needed for the installation.
- For the following installation instructions, it is assumed that the wall has been opened and that the existing shower set has been removed.
- Before you begin, the main water supply to your home should be shut off.

TOOLS AND MATERIALS:



Plumbers
Tape



Adjustable
Wrench



Pencil or
Marker



Tape Measure



Drill



Hex Wrench

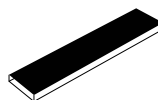

Wood Blocking



Soldering Kit
(for copper pipe)



1/2" Test Plug



Level



SIGNATURE HARDWARE

customer service: 1.866.855.2284
signaturehardware.com

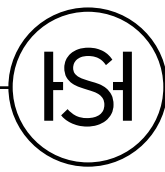

RYLE THERMOSTATIC SHOWER SET INSTALLATION

Step 1: Valve Installation

1. To prepare for installation, wood blocking should be installed between the two studs where the valve will mount. Use the guidelines located on the valve to determine how far behind the finished wall it should mount.

Important: Take into consideration the thickness of the finished wall materials, such as tile, when calculating

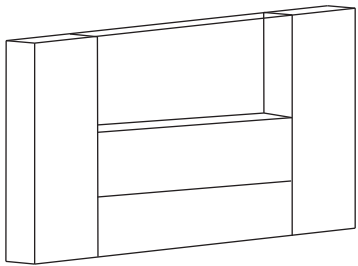

2. Secure the valve to the prepared wood blocking using the provided hardware. Ensure that the "cold" inlet is pointing to the right, and the "hot" inlet is pointing to the left. Use a level to ensure that the valve is straight and level.

Tip: Leave the protective sleeves on the valve stems until your finished wall is complete, and you are ready to install the trim pieces.

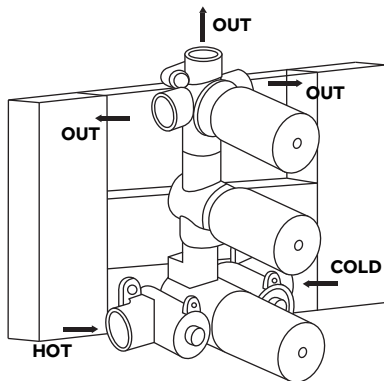

3. Route, assemble, and connect all in-wall piping as desired to and from the shower valve. Make all connections appropriately depending upon the type of pipe that is being used. For copper pipe, soldering will be required and should be completed by a licensed plumber. Apply plumber's tape to any threaded connection if applicable. Install any wood blocking that is necessary to support the piping and valve.

Important Notes:

A) The 3-way diverter is located at the top of the valve. You will use this handle to switch between the overhead shower, handheld shower, and body sprays.

B) Thermostatic temperature control is located at the bottom of the valve. The middle control will serve as volume control.

C) The shower functions will not be able to be used simultaneously. Only one function can be used at a time.

D) Three 1/2" NPT pipe nipple will need to be placed where the supply elbow for the hand shower will be installed.

E) 1/2" IPS female fittings will need to be placed where the overhead shower arm and handshower elbow will be installed.

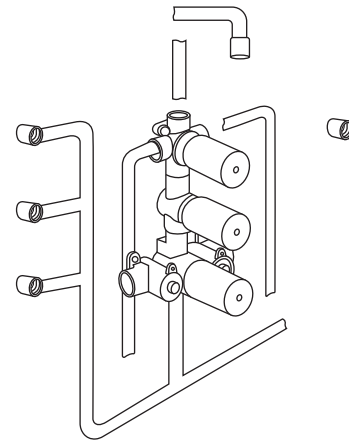



RYLE THERMOSTATIC SHOWER SET INSTALLATION

4. Once all piping is routed and connections have been made, use a ½" test plug to perform a water pressure test. Turn on the main water supply to the home and water test the installed plumbing. Ensure that there are no leaks, then shut the water off. Remove the test plug.

Note: Water pressure testing should be performed by a licensed plumber if you are not familiar with this procedure.

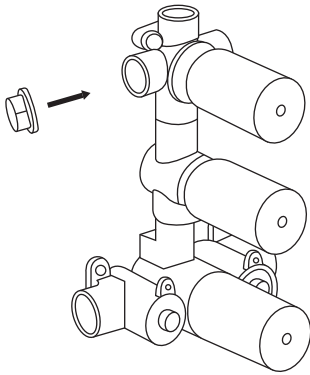

IMPORTANT: COMPLETE THE CONSTRUCTION OF YOUR WALL, INCLUDING ANY FINISHED WALL MATERIALS SUCH AS TILE, BEFORE PROCEEDING WITH THE REMAINDER OF THE INSTALLATION.

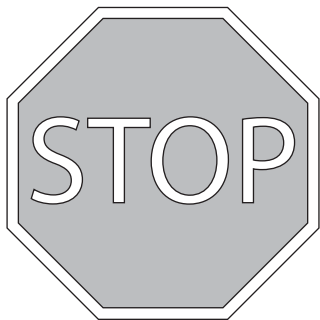

Step 2: Trim Installation

1. Once the finished wall is complete, remove the protective sleeves from the valve stems.

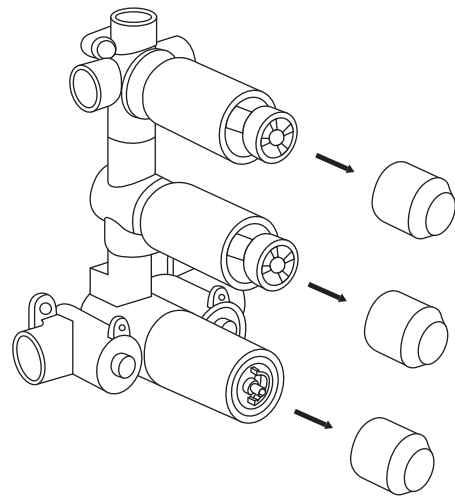

2. Slide the decorative back plate onto the valve.

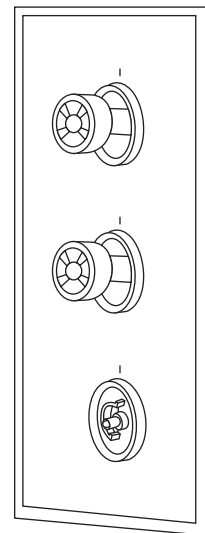



RYLE THERMOSTATIC SHOWER SET INSTALLATION

3. Attach the 3-way diverter knob to the top stem by sliding it onto the spindle and tightening the set screw underneath, using the provided hex wrench. Repeat these steps to install the center volume control knob.

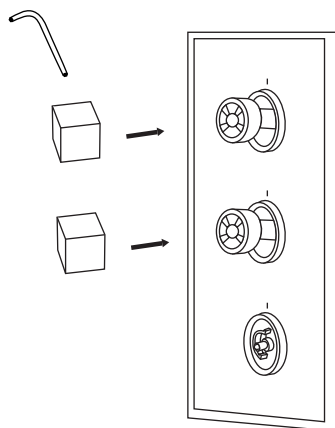

4. Attach the temperature control knob to the bottom stem by sliding it onto the spindle and tightening the set screw underneath, using the provided hex wrench. Ensure that the on/off button is positioned on the top of the knob.

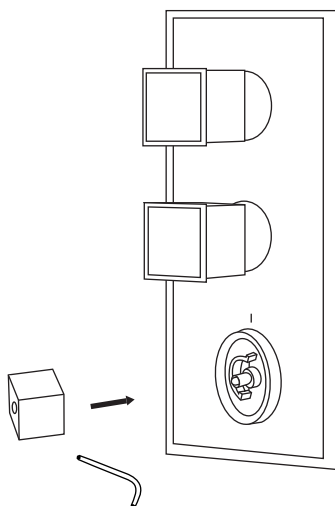

5. To install the hand shower's water supply elbow, thread it into its prepared female fitting. Apply thread sealant or plumber's tape to the threads before tightening.

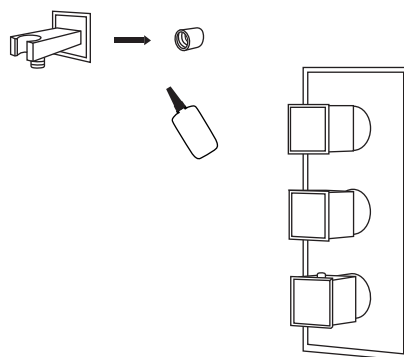

6. Attach the hand shower to the supply elbow using the hand shower hose. Apply thread sealant or plumber's tape to the threads before tightening. Hand tighten the connections firmly.

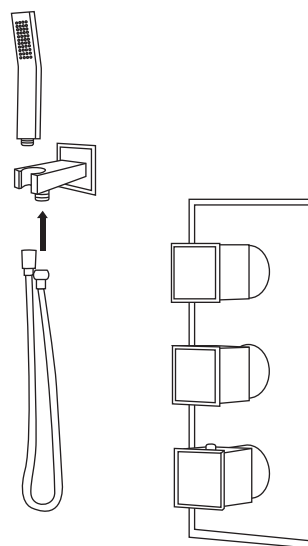

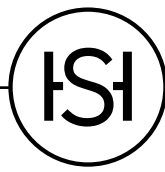

RYLE THERMOSTATIC SHOWER SET INSTALLATION

7. Install each of the body jets by threading them into the prepared female fittings. Be sure to use the decorative escutcheons to conceal the rough-ins. Apply thread sealant or plumber's tape to the threads before tightening.

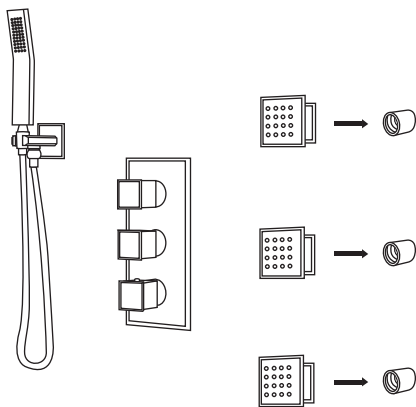

8. Attach the shower arm by threading it into its prepared female fitting. Apply thread sealant or plumber's tape to the threads before tightening.

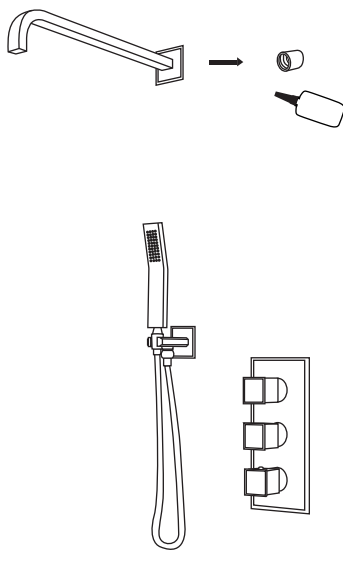

9. Complete the installation by attaching the shower head to the installed shower arm. Apply thread sealant or plumber's tape to the threads before tightening.

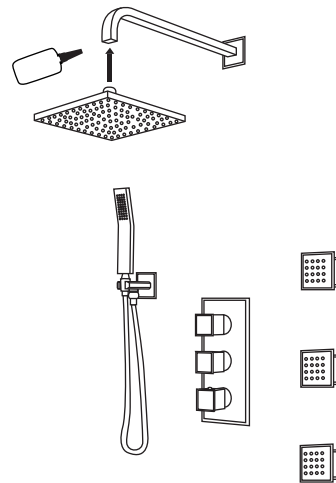

10. Turn the main water supply back on, and test the completed shower system. Ensure that there are no leaks and that all functions are working properly.

