

THERMOSTATIC CONCEALED MIXER WITH 3-WAY DIVERTER

SKU: 940105

Code: SH430480, SH430481



FEATURES

Installation Type: Wall Mount

Features: Thermostatic

Design: Modern

Assembly Required: No

Handle Type: Lever

Installation Type: Wall Mount

Valve Trim Width: 5-1/2"

Valve Trim Height: 8"

Diverter Included: Yes

Diverter Outlets: 4

IAPMO

ASME A112.18.1/CSA B125.1



REVISED 3/17/2023

THERMOSTATIC CONCEALED MIXER WITH 3-WAY DIVERTER

SKU: 940105

Code: SH430480, SH430481



ADDITIONAL FEATURES

- Thermostatic technology keeps shower temperature ± 1 degree Celsius.

REVISED 3/17/2023

THERMOSTATIC CONCEALED MIXER WITH 3-WAY DIVERTER

SKU: 940105

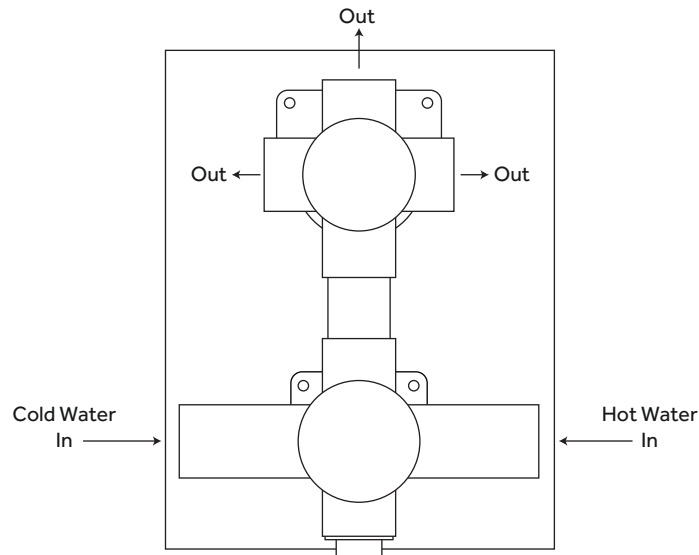
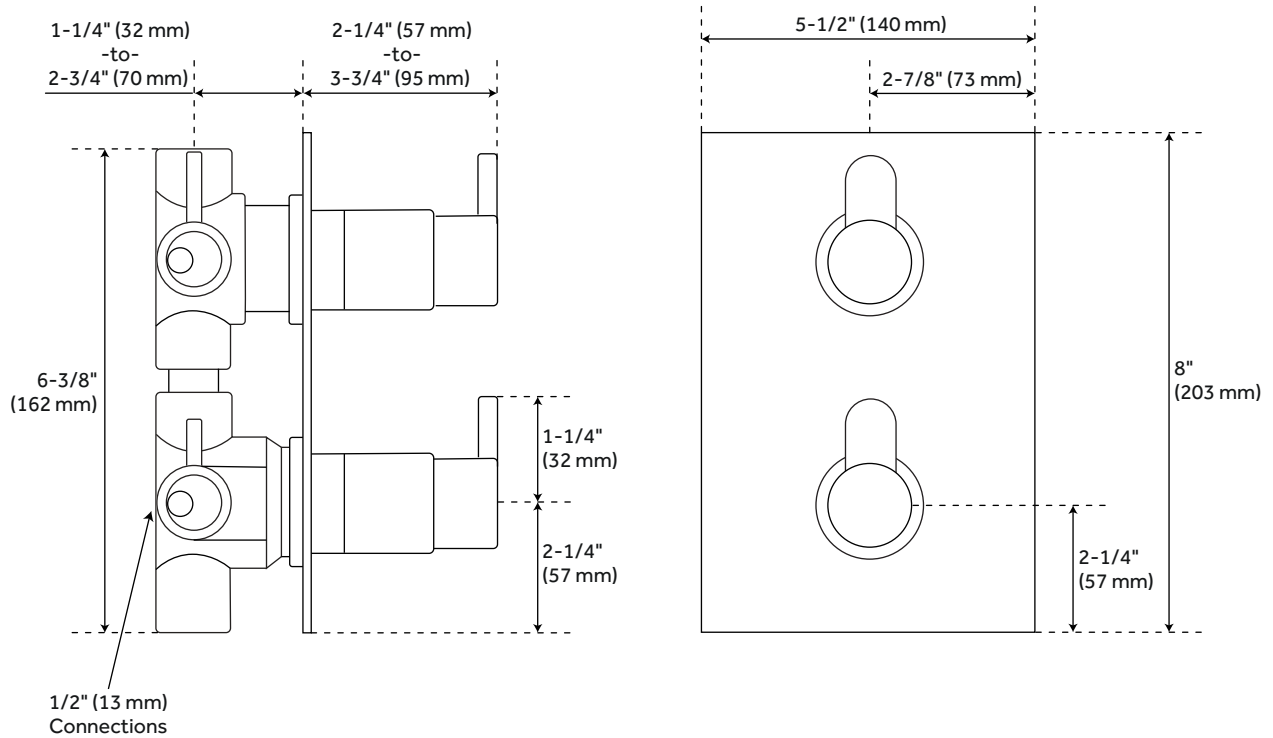

All dimensions and specifications are nominal and may vary. Use actual products for accuracy in critical situations.