

HIBISCUS IN-WALL SHOWER DIVERTER

SKU: 948902

Code: SHHB9005, SH6103



FEATURES

Installation Type: Wall Mount

Design: Modern

Material: Brass

Assembly Required: No

Shape: Square

Handle Type: Lever

Installation Type: Wall Mount

NPT Connection: 3/4"

Valve Trim Width: 4-5/16"

Valve Trim Height: 4-5/16"

Diverter Included: Yes

Diverter Outlets: 1

ASME A112.18.1/CSA B125.1



REVISED 3/22/2023

HIBISCUS IN-WALL SHOWER DIVERTER

SKU: 948902

Code: SHHB9005, SH6103



ADDITIONAL FEATURES

- Metal handle.
- Metal Escutcheon.
- Not intended as a shut off valve.
- Six total settings allow for shared water flow between outlets, giving you the ability to use two functions at once.
- Optional Rough-in Valve:
 - Available Single-Function Diverter Valve Cartridge restricts water flow to one outlet at a time.
 - Brass valve body.
 - Ceramic cartridge.
 - Must be installed in accordance with provided installation instructions.

REVISED 3/22/2023

HIBISCUS IN-WALL SHOWER DIVERTER

SKU: 948902
SHHB9005, SHHB9005Z

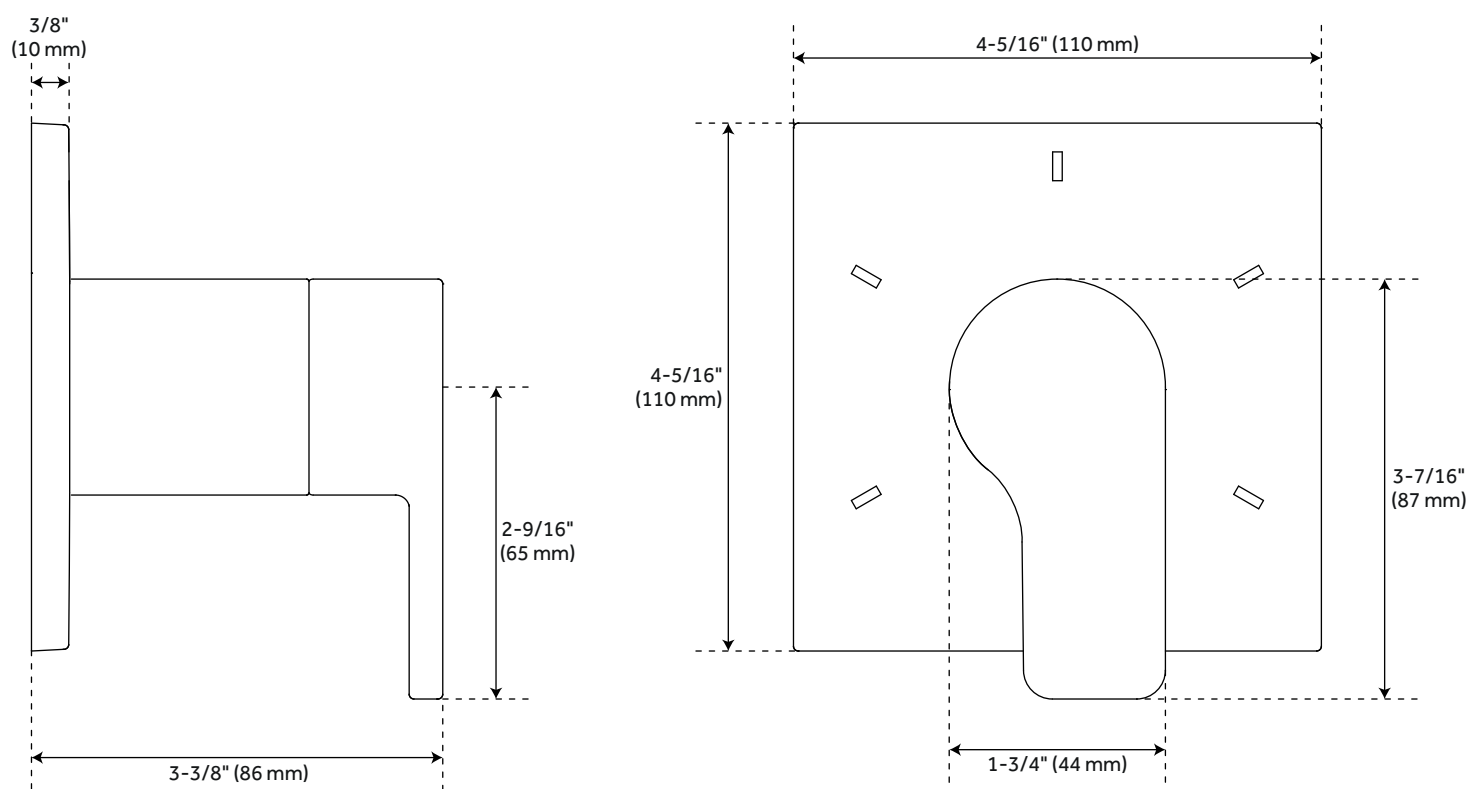

All dimensions and specifications are nominal and may vary. Use actual products for accuracy in critical situations.

HIBISCUS OPTIONAL 3-WAY IN-WALL DIVERTER ROUGH-IN VALVE - 3/4"

SKU: 948902
SH6103

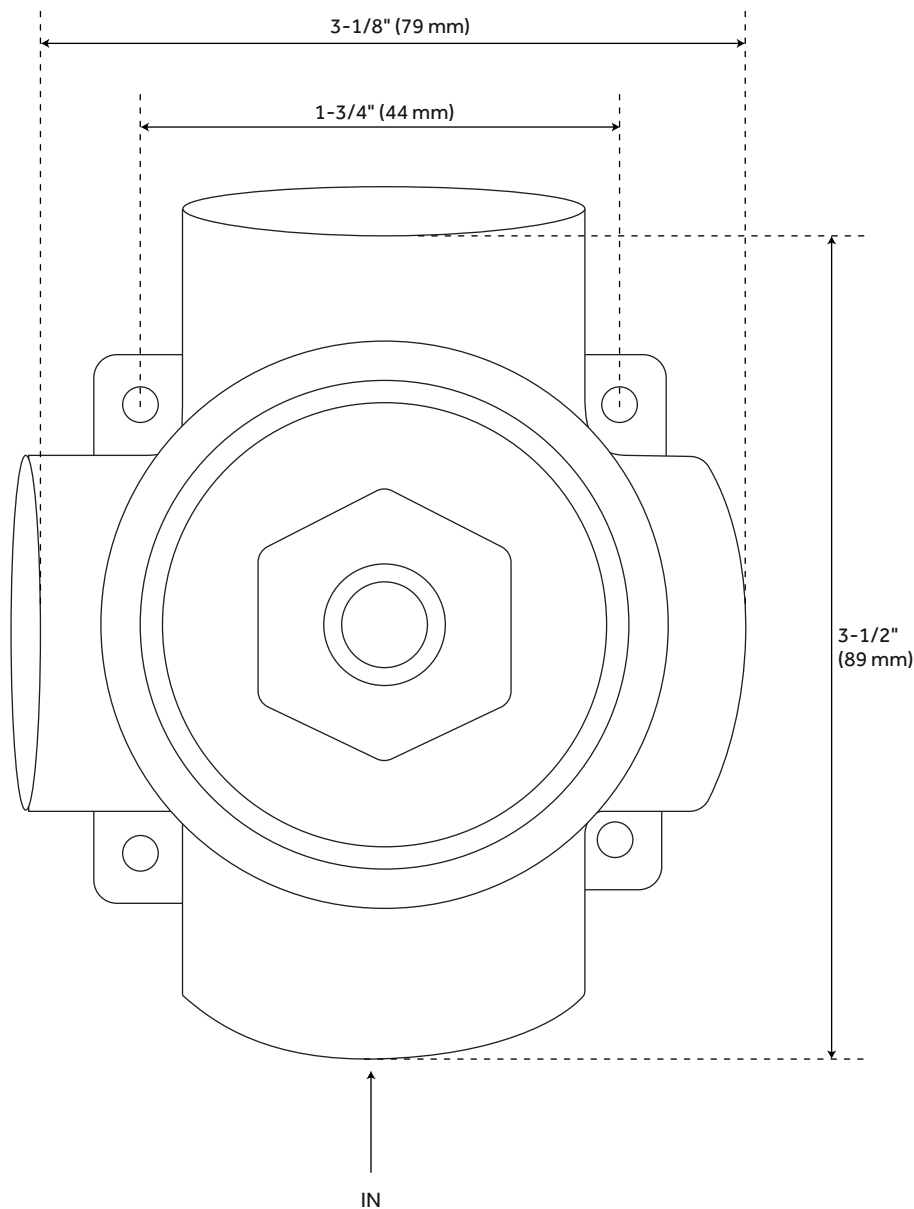

All dimensions and specifications are nominal and may vary. Use actual products for accuracy in critical situations.