

# 60" HAL BARN DOOR HARDWARE KIT

SKU: 950667

Code: HBD5000X60, HBD5911

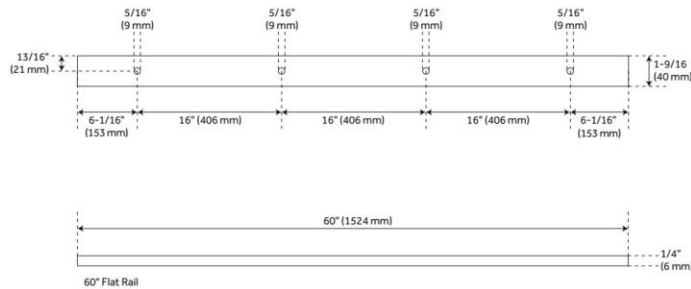

## FEATURES

Material: Steel

## ADDITIONAL FEATURES

- Brushed nickel, oil rubbed bronze, black, and champagne brass finishes are made of steel.
- Stainless steel finish is made of stainless steel.
- For doors up to 30" wide.
- Wheel: 2-3/4" diameter.
- Steel 1-1/4" diameter roller bearings.
- Track Size: 1/4" steel, 1-1/2" x 60".
- Strap Size: 1/4" Steel, 11-1/2" x 1-1/2".
- Max weight capacity is 176lbs, but the recommended door weight for optimal performance is 66-132lbs.
- Optional Soft Close Adapter:
  - For use with flat rails.
  - Steel construction for long lasting durability.
  - Keep door from slamming when opening and closing.
  - Installs concealed behind the wall.
- Soft close kit includes:
  - Low profile soft close adapter left hand (1).
  - Low profile soft close adapter right hand (1).
  - Low profile soft close trigger (2).
  - Trigger screws (6).
  - Cone-point set screws (8).
  - Allen wrench for set screws (1).
  - Width: 12-11/16". Depth: 1-1/4". Height: 1-1/8".

REVISED 8/14/2025

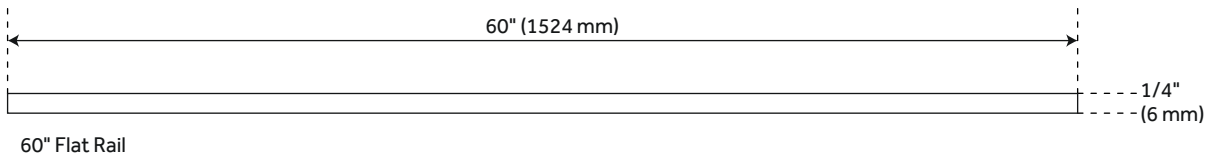
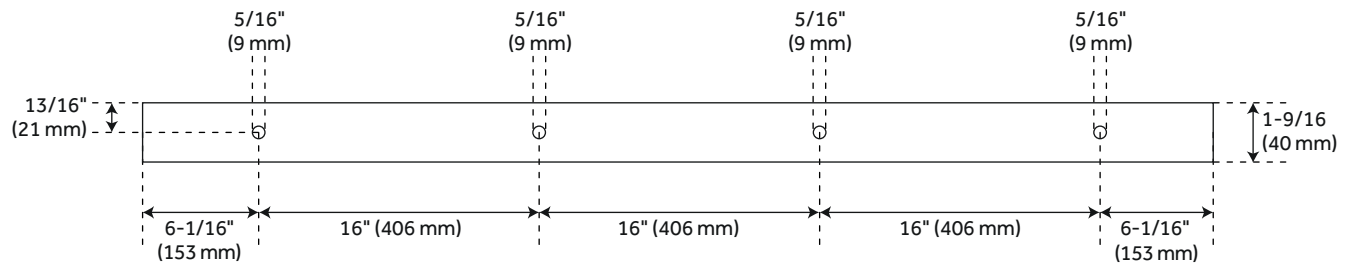

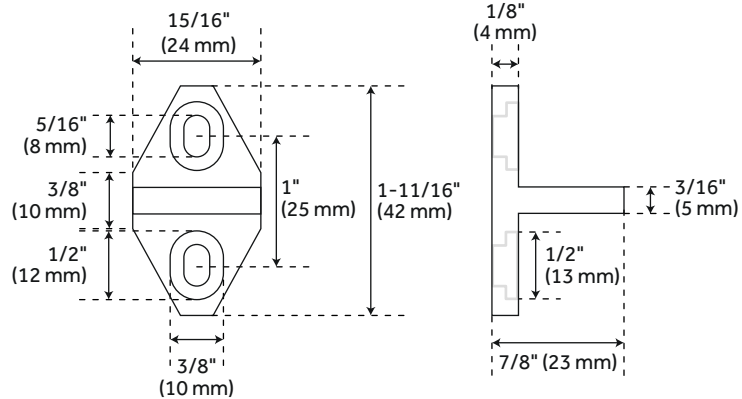

Mortise Floor Guide

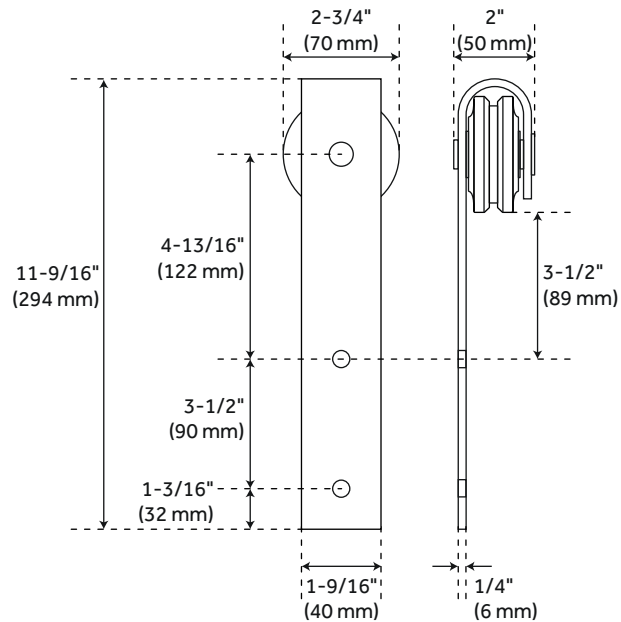

Bent Strap Hanger - Standard Wheel

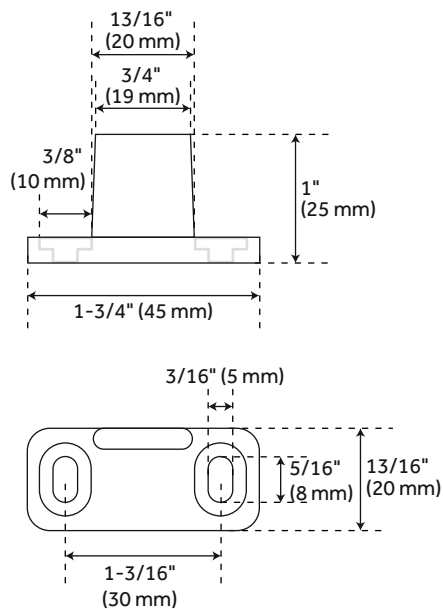

Non-Mortise Floor Guide

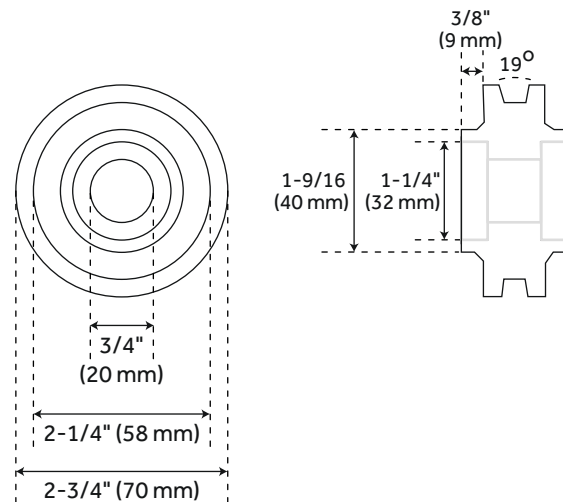

Standard Wheel

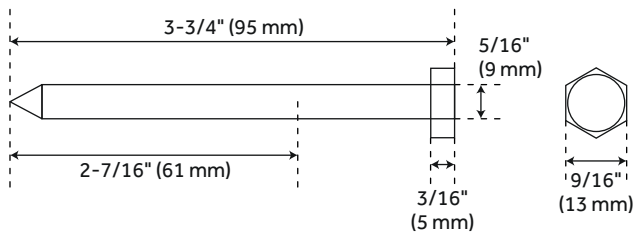

Track Lag Bolt

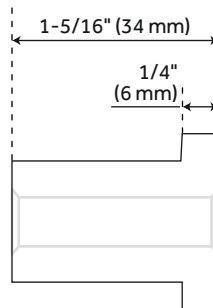

Flat Rail Spacer

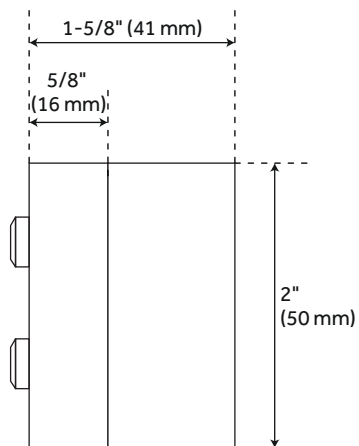
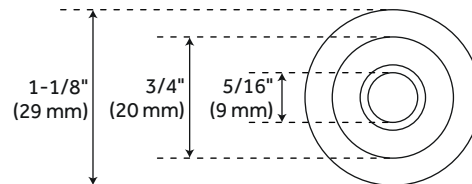

Flat Rail Stop Standard

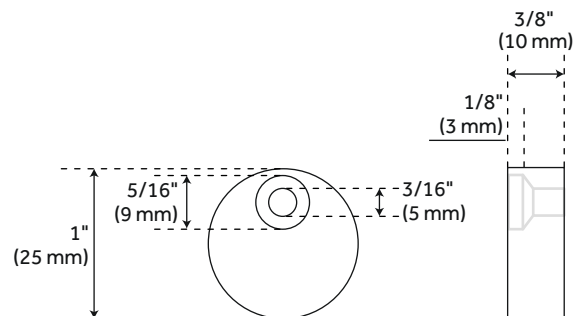
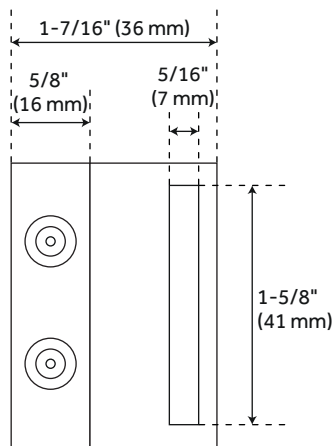

Anti Jump Disk