

VASSOR PRESSURE BALANCE TUB AND SHOWER SYSTEM

SKU: 953801

Code: SHVA8010, SH4001, SHRSA122, SHRSB820RG, SHTS72, SHTS73



FEATURES

Material: Metal

Shower Head Swivel: Yes

Shower Head Spray: Rainfall

Shower Head Flow Rate: 1.75 gpm (6.6 L/min) @ 80 psi

Flow Rate: Rough-in Valve Capacity: 6.3 gpm (23.8 L/min) @ 80 psi

Connection Type: 1/2" MIP and SWT

Cartridge Type: Ceramic Disc

ASME A112.18.1/CSA B125.1, ASSE 1016 Type P, CEC Listed, WaterSense by IAPMO, Massachusetts Accepted, LISTED ID: SHVA8010*, SHRSB820RG*, SHTS73*, SH4001, SHRSA122*



ADDITIONAL FEATURES

- Single function shower head.
- Tub spout diverter.
- Slip-fit tub spout.
- Included Pressure balance valve with integral stops.
 - One-piece cartridge design for ease of maintenance.
 - Back-to-back capability.
 - Ceramic disc valve cartridge.
 - Cast bronze valve body.
 - Adjustable temperature limit stop.
 - Quick remove plaster guard.
 - Easy mounting brackets.

REVISED 9/10/2025

8" MODERN ROUND RAINFALL SHOWER HEAD -1.75 GPM

SKU: 948948-18

Code: SHRSB820RG



FEATURES

Material: ABS

Shower Head Swivel: Yes

Shower Head Spray: Rainfall

Shower Head Flow Rate: 1.75 gpm (6.6 L/min) @ 80 psi

Connection Type: NPSM

ASME A112.18.1/CSA B125.1, CEC Listed, WaterSense by IAPMO, Massachusetts Accepted, LISTED ID: SHRSB820RG*



ADDITIONAL FEATURES

- Single function shower head (full spray).
- Easy clean rubber nozzles.
- Brass ball joint.

REVISED 9/10/2025

8" MODERN ROUND RAINFALL SHOWER HEAD -1.75 GPM

SKU: 948948-18
Code: SHRSB820RG

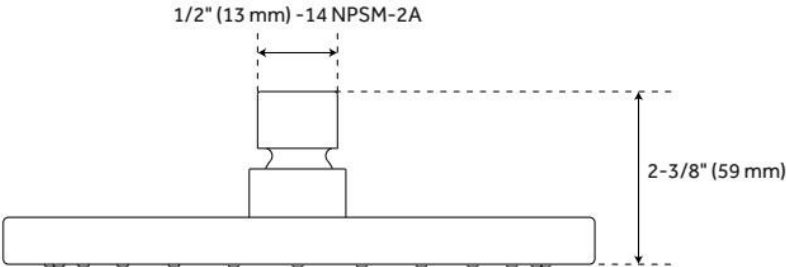
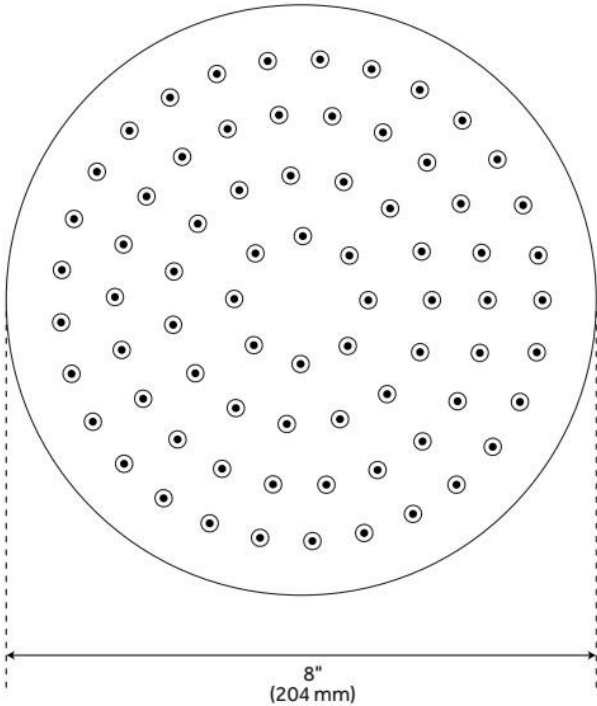

REVISED 9/10/2025

CYLINDRICAL WALL-MOUNT SHOWER ARM

SKU: 953769
Code: SHRSA122

FEATURES

Material: Metal
Connection Type: 1/2" NPT



ASME A112.18.1/CSA B125.1, Massachusetts Accepted, LISTED ID: SHRSA122*



ADDITIONAL FEATURES

- Escutcheon included.

REVISED 9/10/2025

CYLINDRICAL WALL-MOUNT SHOWER ARM

SKU: 953769
Code: SHRSA122

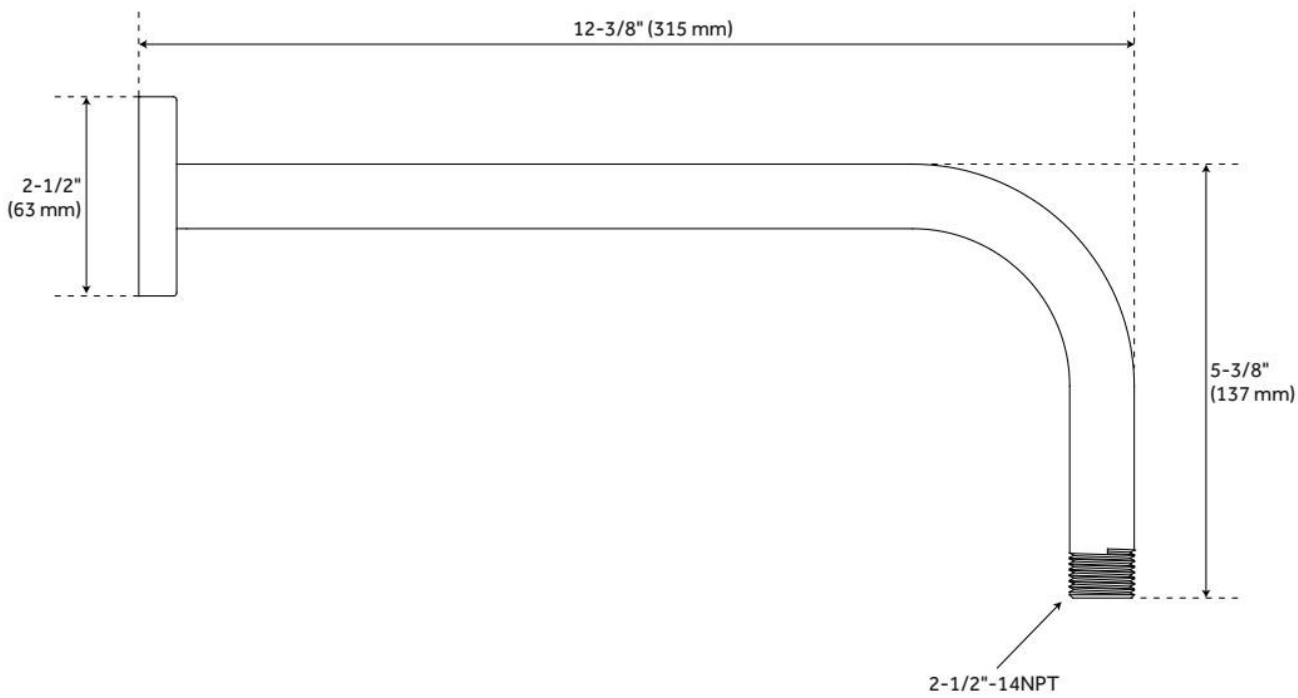

REVISED 9/10/2025

LEXIA TUB SPOUT WITH DIVERTER

SKU: 953768
Code: SHTS73



FEATURES

Material: Metal

Connection Type: 1/2" CTS Slip-Fit

ASME A112.18.1/CSA B125.1, CEC Listed, Massachusetts Accepted, LISTED ID: SHTS73*



ADDITIONAL FEATURES

- 1/2" CTS Slip-Fit connection.

REVISED 9/10/2025

LEXIA TUB SPOUT WITH DIVERTER

SKU: 953768
Code: SHTS73

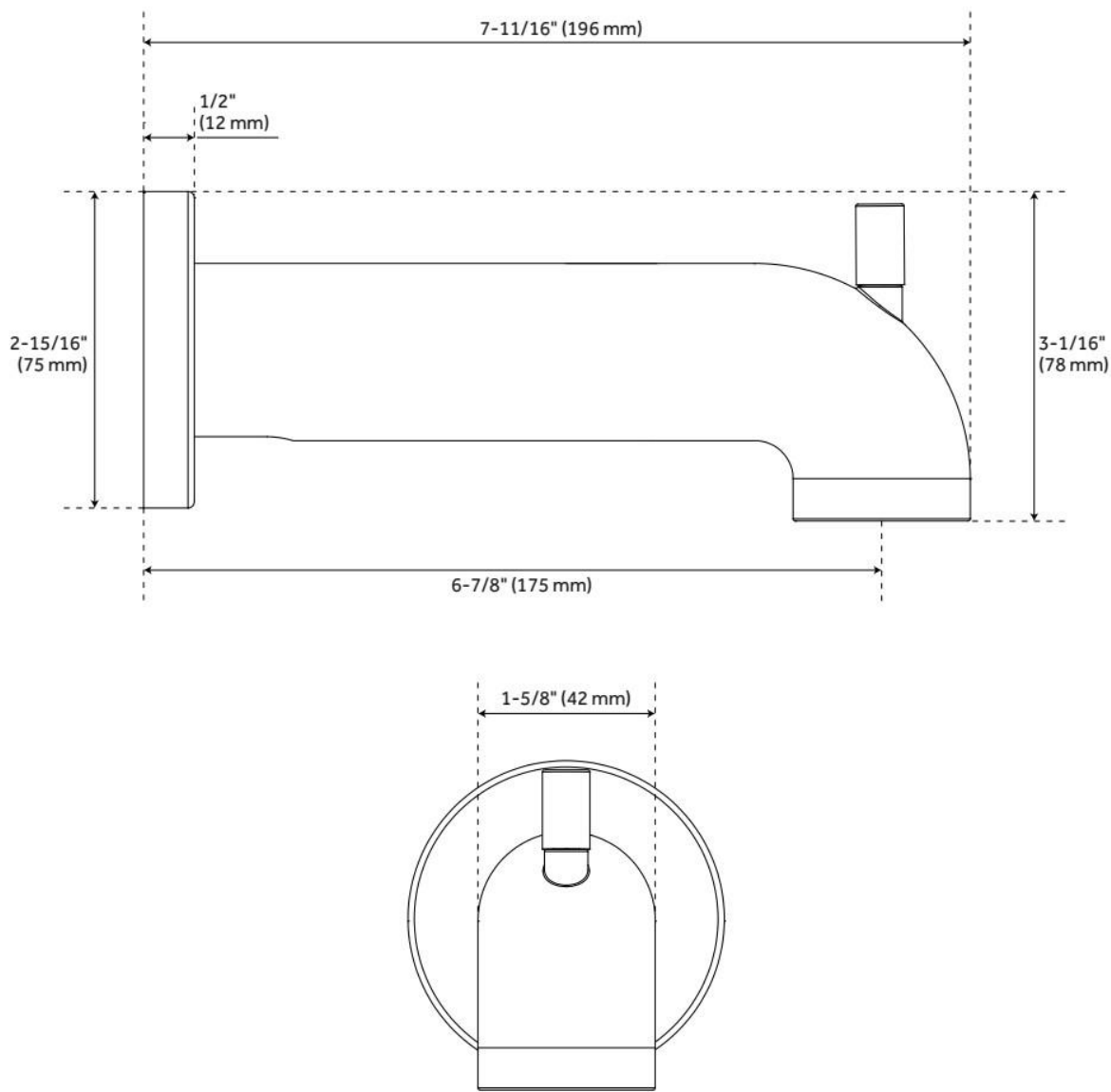

REVISED 9/10/2025

VASSOR PRESSURE BALANCE SHOWER VALVE

SKU: 953799

Code: SHVA8010, SH4001



FEATURES

Material: Metal

Flow Rate: Rough-in Valve Capacity: 6.3 gpm (23.8 L/min) @ 80 psi

Connection Type: 1/2" MIP and SWT

Cartridge Type: Ceramic Disc

ASME A112.18.1/CSA B125.1, ASSE 1016 Type P, Massachusetts Accepted, LISTED ID: SHVA8010*, SH4001



ADDITIONAL FEATURES

- Metal handle.
- Metal escutcheon.
- Optional Rough-in Valve:
 - Pressure balance valve with integral stops.
 - One-piece cartridge design for ease of maintenance.
 - Back-to-back capability.
 - Ceramic disc valve cartridge.
 - Cast bronze valve body.
 - Adjustable temperature limit stop.
 - Quick remove plaster guard.
 - Easy mounting brackets.
 - Complete the look with the coordinating
 - <https://www.signaturehardware.com/collections/lexia-collection?srule=bestseller->

REVISED 9/10/2025

VASSOR PRESSURE BALANCE SHOWER VALVE

SKU: 953799
Code: SHVA8010, SH4001

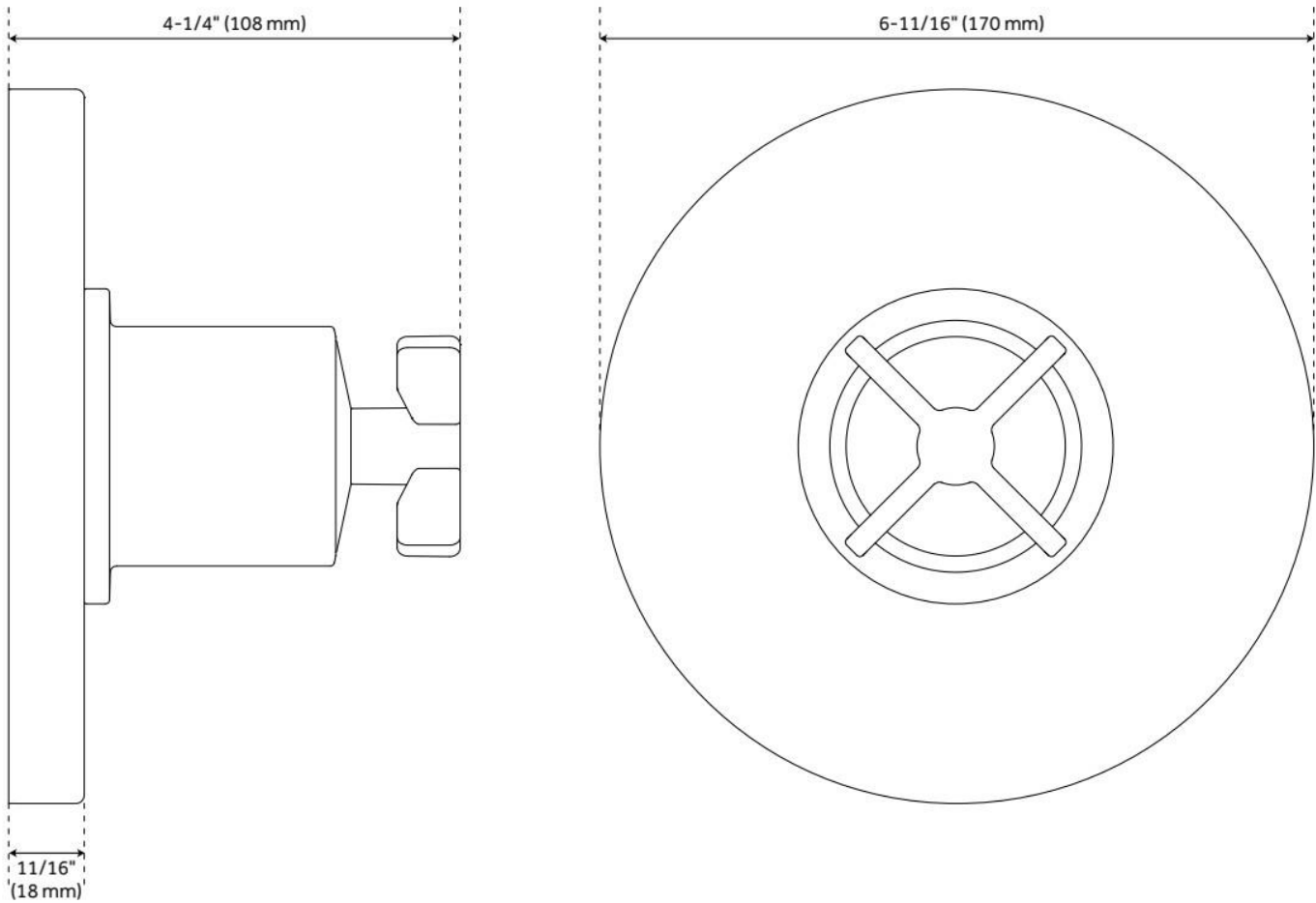

REVISED 9/10/2025

PRESSURE BALANCE TUB & SHOWER ROUGH-IN VALVE

SKU: 446520
Code: SH4001



FEATURES

Material: Brass

Flow Rate: Rough-in Valve Capacity: 6.3 gpm (23.8 L/min) @ 80 psi

Connection Type: 1/2" MIP and SWT

Cartridge Type: Ceramic Disc

ASME A112.18.1/CSA B125.1, ASSE 1016 Type P, Massachusetts Accepted, LISTED ID: SH4001



ADDITIONAL FEATURES

- Pressure balance valve with integral stops.
- One-piece ceramic cartridge design for ease of maintenance.
- Back-to-back capability
- Adjustable temperature limit stop.
- Quick remove plaster guard and easy mounting brackets.

REVISED 9/10/2025

PRESSURE BALANCE TUB & SHOWER ROUGH-IN VALVE

SKU: 446520
Code: SH4001

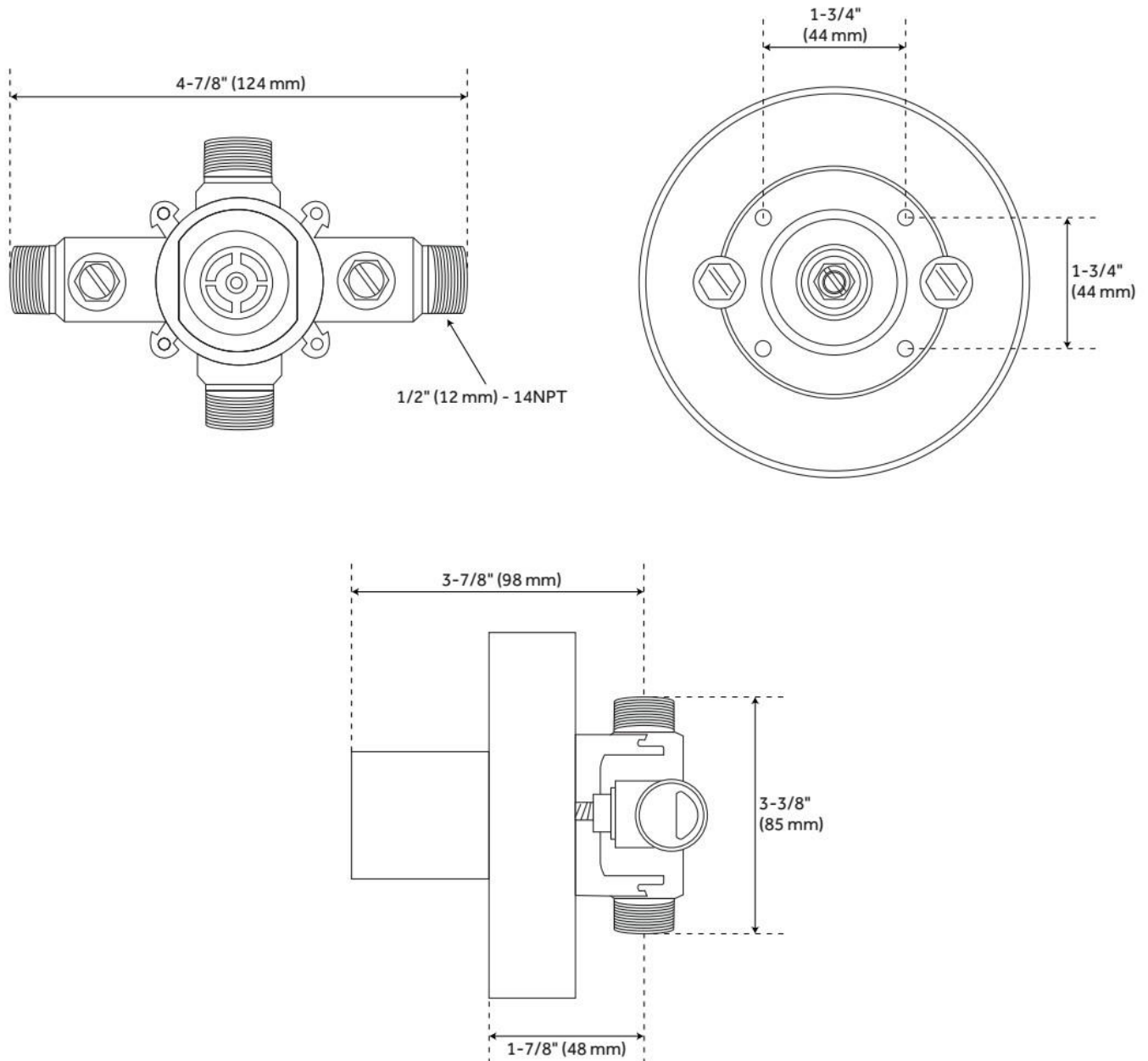

REVISED 9/10/2025