

HIBISCUS PRESSURE BALANCE SHOWER SYSTEM

SKU: 953889

Code: SHHB8010,SH4001,SHRSA120S,SHSH2080G



FEATURES

Installation Type: Wall
Features: Pressure-Balanced
Design: Modern
Mounting Hardware Included: Yes
Assembly Required: No
Handle Type: Lever
NPT Connection: 1/2"
Shower Head Installation Type: Wall-Mount
Number of Shower Heads: 1
Shower Head Material: 304-Grade Stainless Steel
Shower Head Spray: Rainfall
Shower Head Length: 7-7/8"
Shower Head Width: 7-7/8"
Shower Arm Included: Yes
Shower Arm Extension: 12"
Shower Arm Height: 2-3/8"
Shower Head IPS: 1/2"
Shower Head Swivel: Yes
Valve Trim Width: 6-11/16"
Valve Trim Height: 6-11/16"
Diverter Included: No
Shower Head Flow Rate: 1.8 gpm (6.8 L/min) @ 80 psi

WaterSense by IAPMO

LISTED ID: SHHB8010*, SH4001, SHRSA120S*,
SHSH2080G*



REVISED 1/26/2024

HIBISCUS PRESSURE BALANCE SHOWER SYSTEM

SKU: 953889

Code: SHHB8010,SH4001,SHRSA120S,SHSH2080G



ADDITIONAL FEATURES

- Pressure balance valve with integral stops.
- One-piece cartridge design for ease of maintenance.
- Back-to-back capability.
- Ceramic disc valve cartridge.
- Cast bronze valve body.
- Adjustable temperature limit stop.
- Quick remove plaster guard.
- Easy mounting brackets.

REVISED 1/26/2024

PRESSURE BALANCE TUB AND SHOWER ROUGH-IN VALVE

SKU: 446520
SH4001

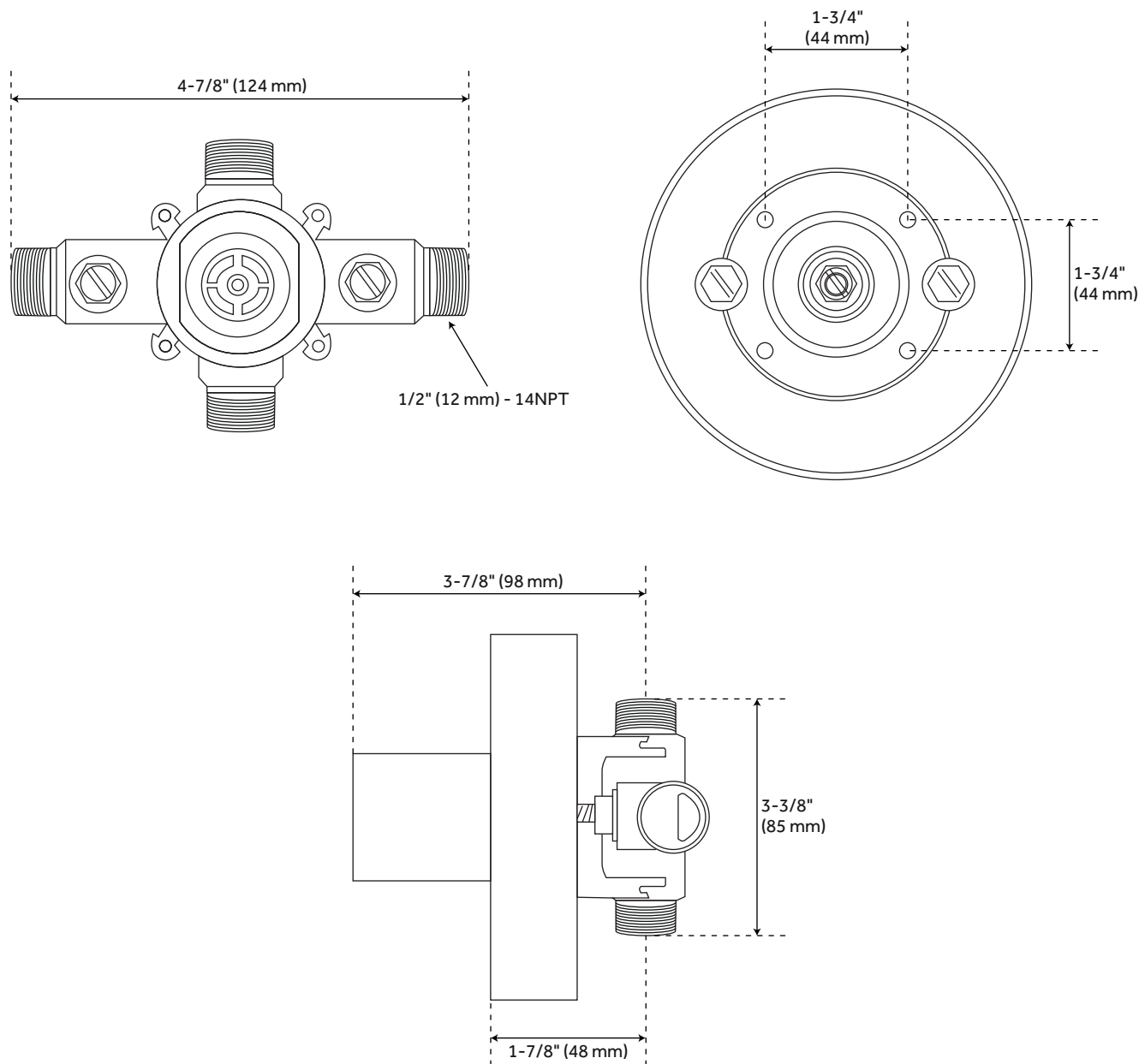

All dimensions and specifications are nominal and may vary. Use actual products for accuracy in critical situations.

HIBISCUS PRESSURE BALANCE SHOWER VALVE

SKU: 948891
SHHB8010

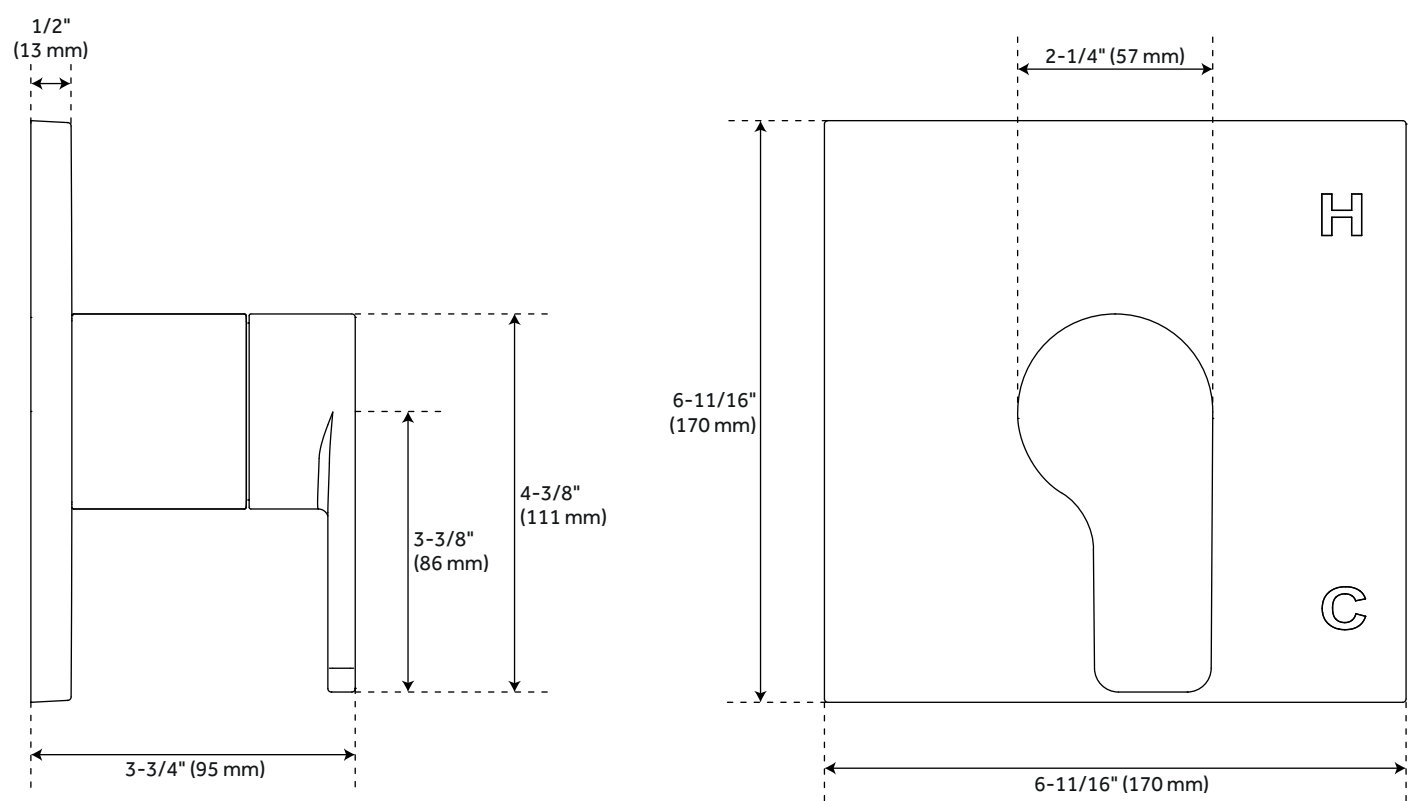

All dimensions and specifications are nominal and may vary. Use actual products for accuracy in critical situations.

HIBISCUS OPTIONAL PRESSURE BALANCE TUB AND SHOWER ROUGH IN VALVE

SKU: 948891
SH4001

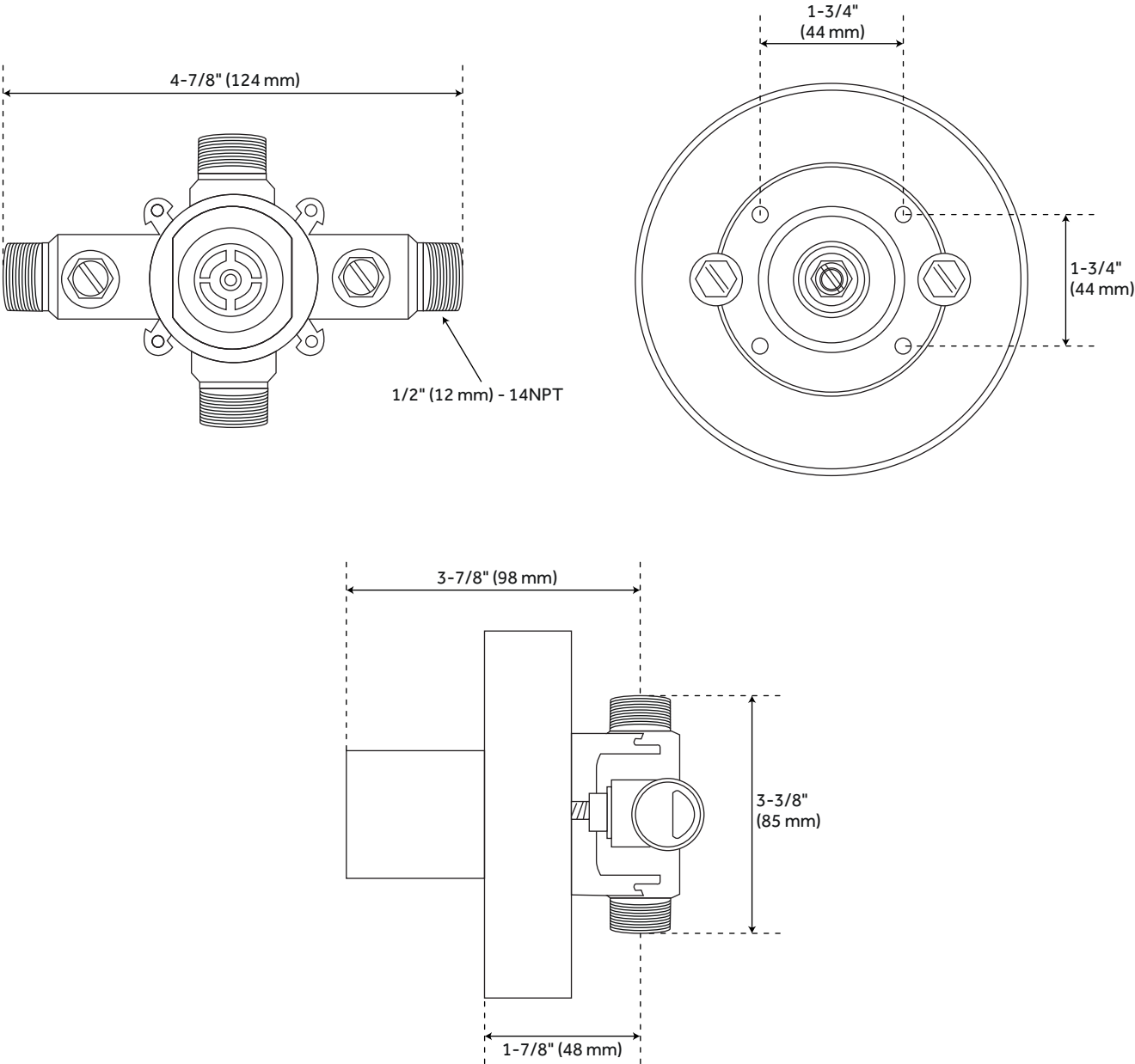

All dimensions and specifications are nominal and may vary. Use actual products for accuracy in critical situations.

MODERN SQUARE WALL-MOUNT SHOWER ARM WITH FLANGE

SKU: 948956
SHRSA120S, SHRSA120SZ, SHRSA180S, SHRSA180Z

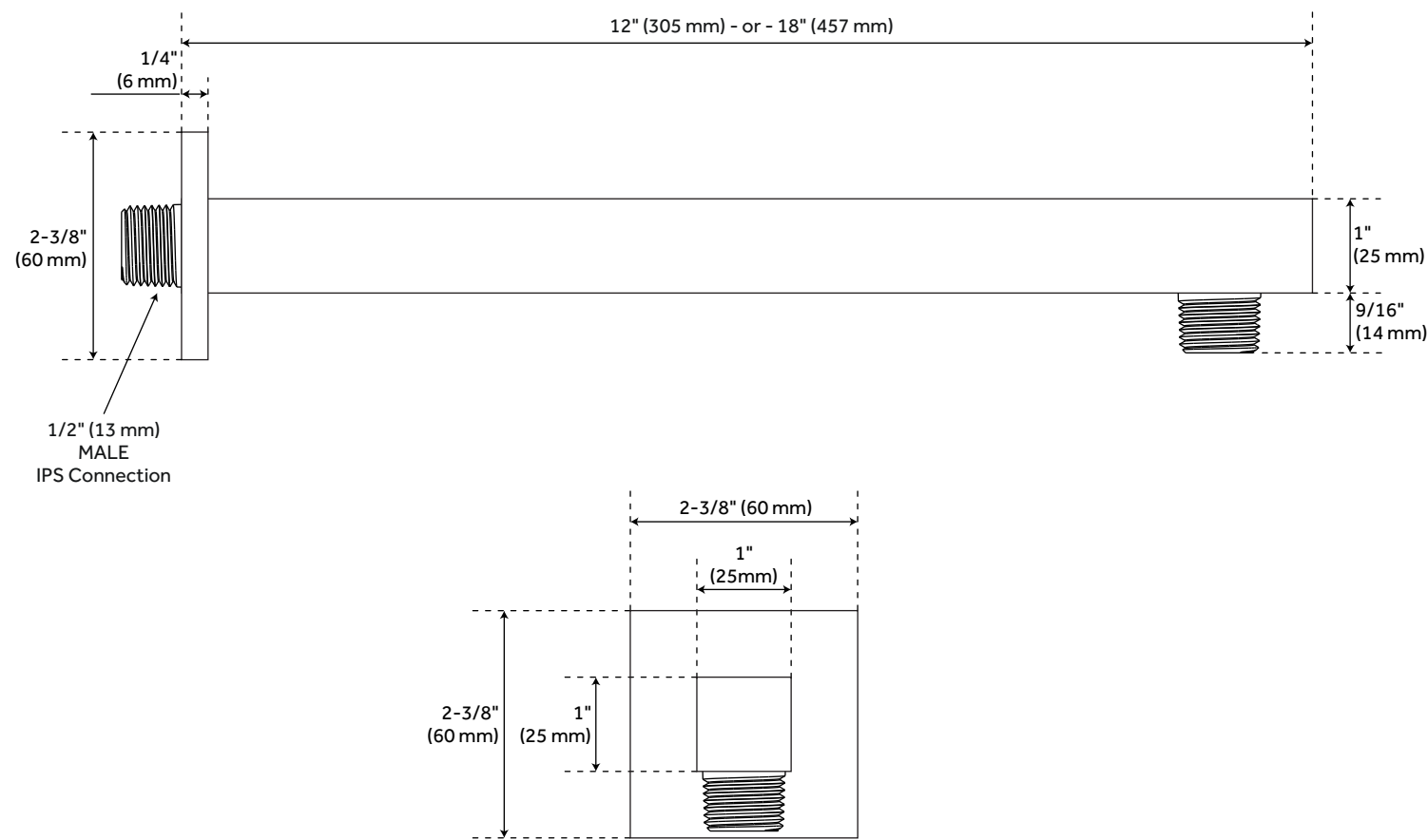

All dimensions and specifications are nominal and may vary. Use actual products for accuracy in critical situations.