

HIBISCUS PRESSURE BALANCE SHOWER SYSTEM WITH SLIDE BAR AND HAND SHOWER

SKU: 953891

Code: SHHB8010,SH4001,SHRSA120S,SHSH2080G,SHHS4080G,SHH1010,SHWE2020,SHSB3050,SHHB9005,SH6103,SHHB8010Z,SH4001Z,SHRSA120SZ,SHSH2080GZ,SHHS4080GZ,SHH1010Z,SHWE2020Z,SHSB3050Z,SHHB9005Z,SH6103Z



FEATURES

Mounting Hardware Included: Yes
Assembly Required: No
Handle Type: Lever
NPT Connection: 1/2"
Shower Head Installation Type: Wall-Mount
Number of Shower Heads: 1
Shower Head Material: 304-Grade Stainless Steel
Shower Head Spray: Rainfall
Shower Head Length: 11-3/4"
Shower Head Width: 11-3/4"
Shower Arm Included: Yes
Shower Arm Extension: 12"
Shower Arm Height: 2-3/8"
Shower Head IPS: 1/2"
Shower Head Swivel: Yes
Valve Trim Width: 6-11/16"
Valve Trim Height: 6-11/16"
Slide Bar Length: 30"
Hand Shower Length: 8-7/16"
Hand Shower Hose Length: 60"
Hand Shower Material: Brass
Hand Shower Flow Rate: 1.8 gpm (6.8 L/min) @ 80 psi
Diverter Included: Yes
Shower Head Flow Rate: 1.8 gpm (6.8 L/min) @ 80 psi

ASME A112.18.1/CSA B125.1

ASSE 1016 Type P

ICC/ANSI A117.1

CEC Listed

Massachusetts Accepted

LISTED ID: SHHB8010*, SH4001, SHRSA120S*,
SHSH2080G*, SHHS4080G*, SHH1010*, SHWE2020*,
SHHB9005*, SH6103



REVISED 7/7/2023

HIBISCUS PRESSURE BALANCE SHOWER SYSTEM WITH SLIDE BAR AND HAND SHOWER

SKU: 953891

Code: SHHB8010,SH4001,SHRSA120S,SHSH2080G,SHHS4080G,SHH1010,SHWE2020,SHSB3050,SHHB9005,SH6103,SHHB8010Z,SH4001,SHRSA120SZ,SHSH2080GZ,SHHS4080GZ,SHH1010Z,SHWE2020Z,SHSB3050,SHHB9005Z,SH6103



ADDITIONAL FEATURES

- Metal lever handle.
- Single function 8" Rainfall shower head.
- Single function hand shower with easy-clean spray nozzles.
- 60" - 72" stretchable metal shower hose.
- Included Rough-in valves:
- Pressure balance valve features a one-piece cartridge design for ease of maintenance, back-to-back capability, a ceramic disc cartridge, cast bronze valve body, adjustable temperature limit stop, a quick remove plaster guard, easy mounting brackets and integral stops.
- Ceramic cartridge.
- Diverter valve features a ceramic disc cartridge and brass valve body. An available Single-Function Diverter valve Cartridge restricts water flow to one outlet at a time.

REVISED 7/7/2023

PRESSURE BALANCE TUB AND SHOWER ROUGH-IN VALVE

SKU: 446520
SH4001

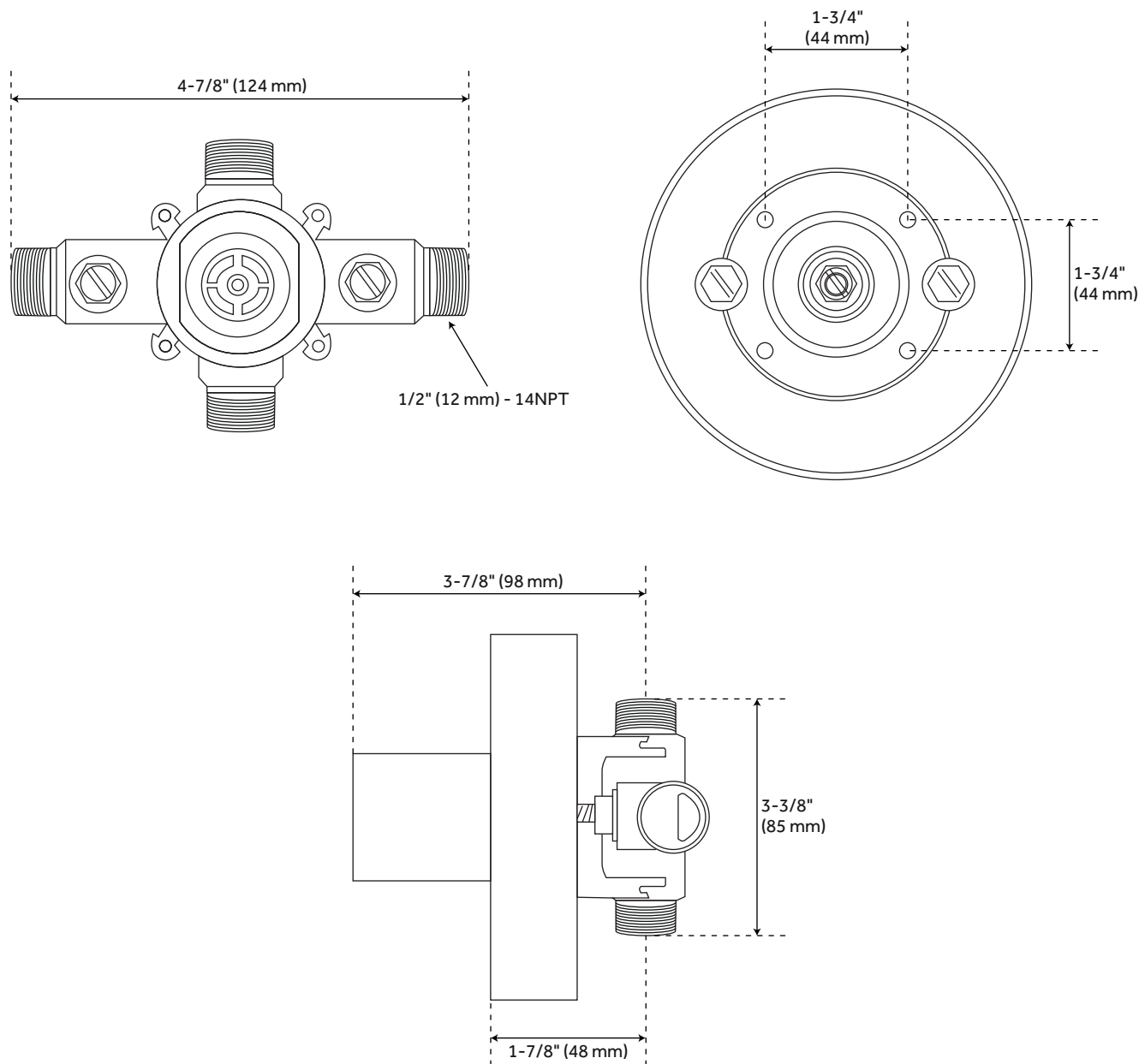

All dimensions and specifications are nominal and may vary. Use actual products for accuracy in critical situations.

HIBISCUS PRESSURE BALANCE SHOWER VALVE

SKU: 948891
SHHB8010

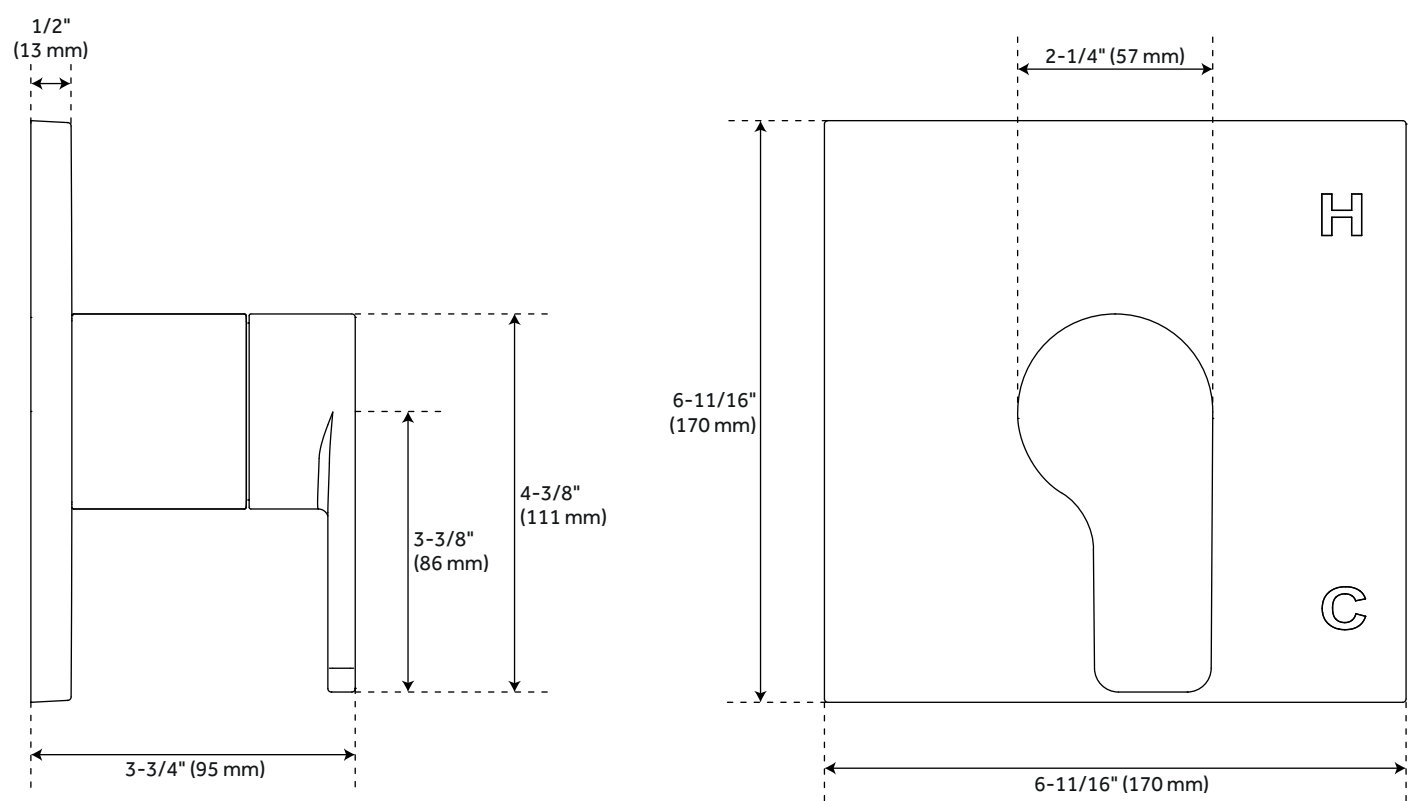

All dimensions and specifications are nominal and may vary. Use actual products for accuracy in critical situations.

HIBISCUS OPTIONAL PRESSURE BALANCE TUB AND SHOWER ROUGH IN VALVE

SKU: 948891
SH4001

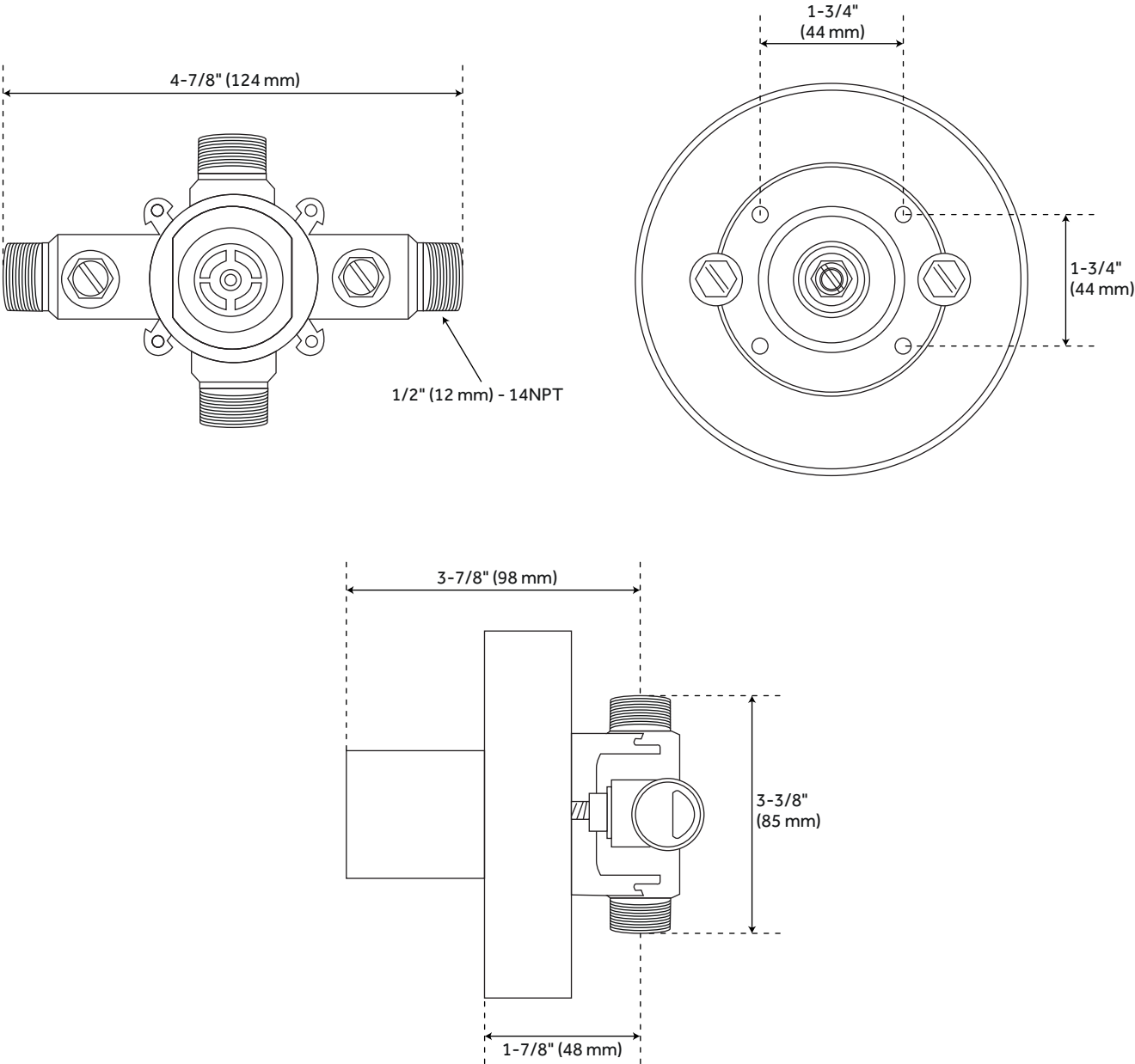

All dimensions and specifications are nominal and may vary. Use actual products for accuracy in critical situations.

HIBISCUS IN-WALL SHOWER DIVERTER

SKU: 948902
SHHB9005, SHHB9005Z

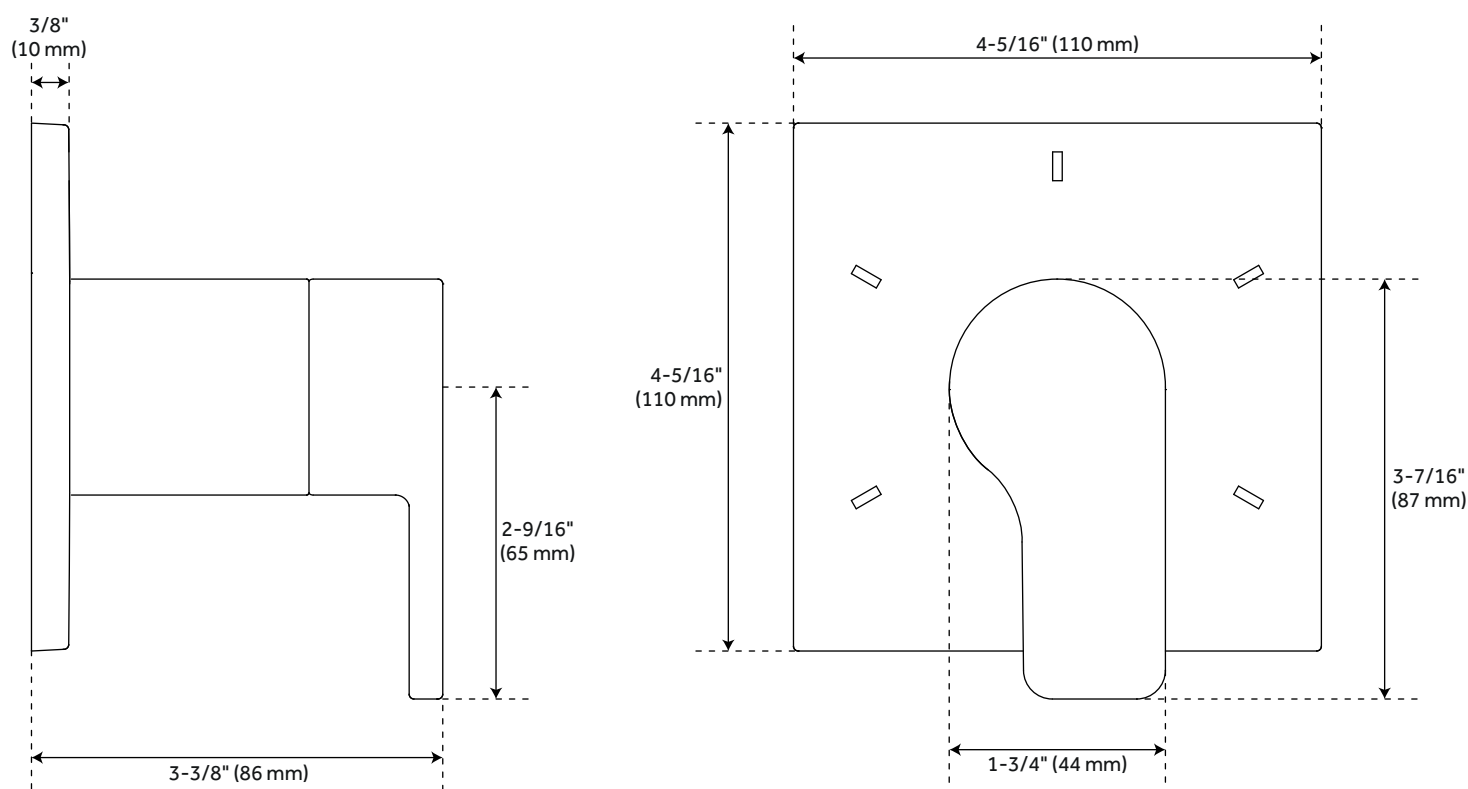

All dimensions and specifications are nominal and may vary. Use actual products for accuracy in critical situations.

HIBISCUS OPTIONAL 3-WAY IN-WALL DIVERTER ROUGH-IN VALVE - 3/4"

SKU: 948902
SH6103

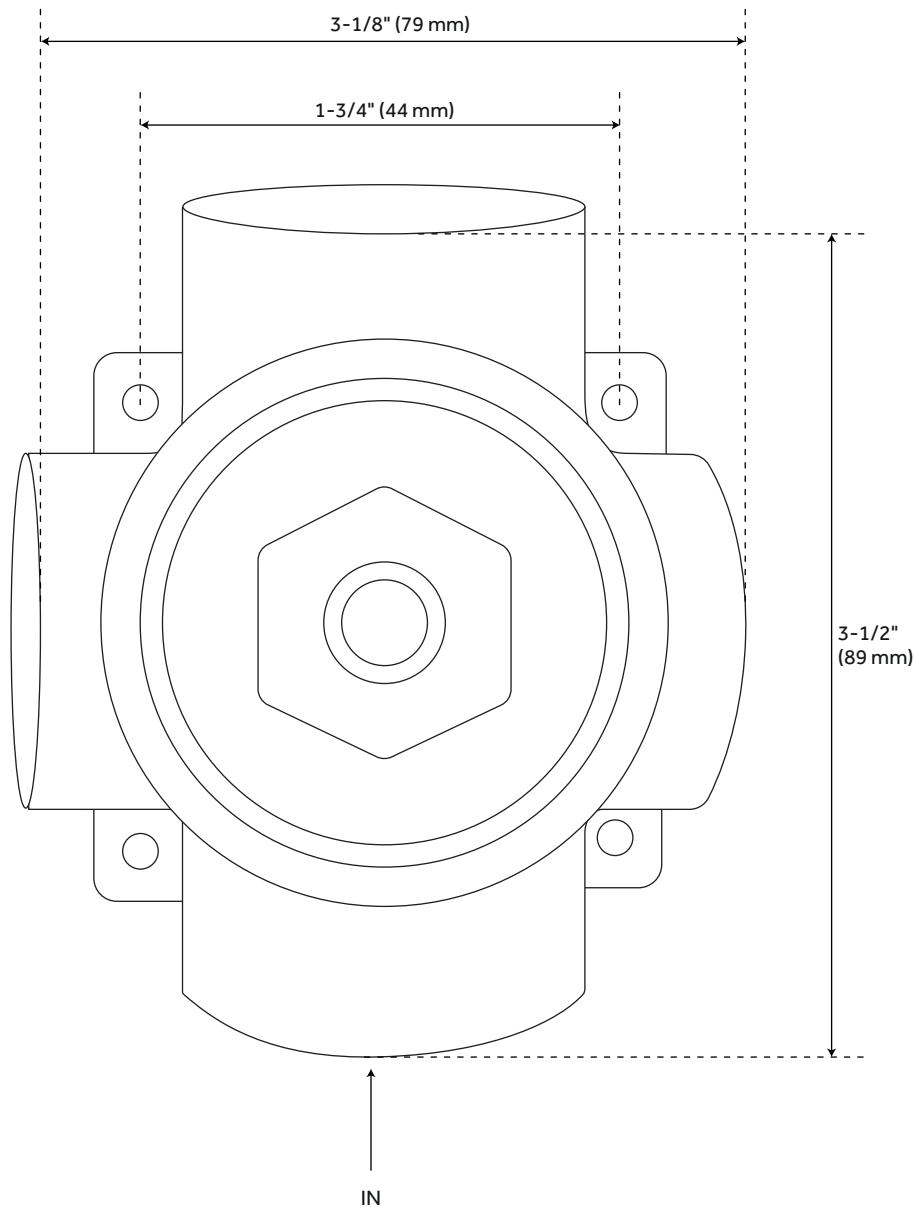

All dimensions and specifications are nominal and may vary. Use actual products for accuracy in critical situations.

CONTEMPORARY SQUARE WATER SUPPLY ELBOW FOR HAND SHOWER

SKU: 948933
SHWE2020

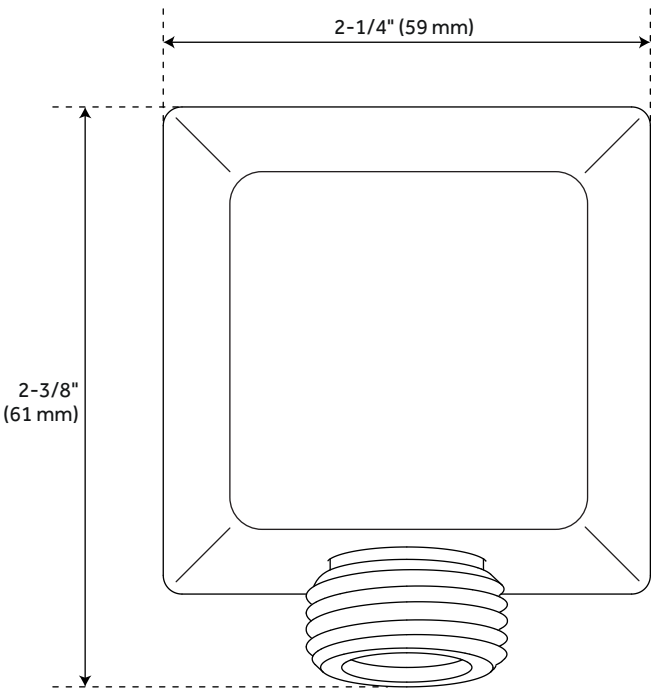
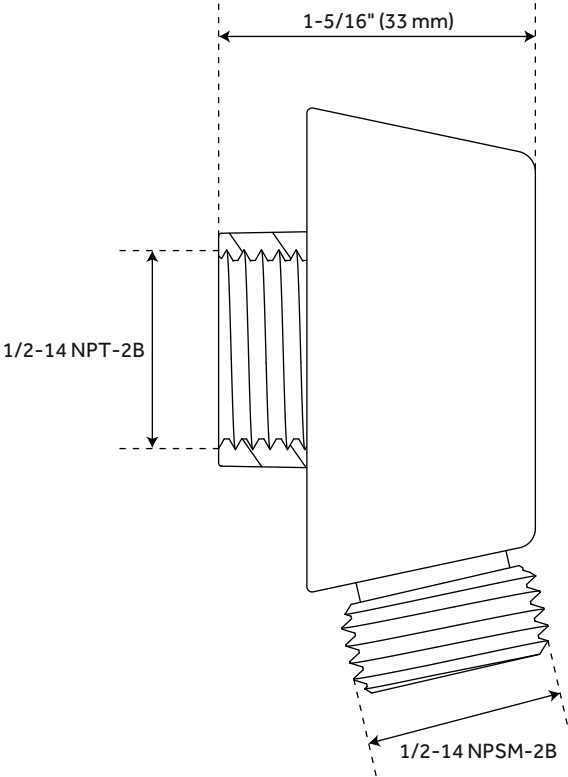

All dimensions and specifications are nominal and may vary. Use actual products for accuracy in critical situations.

60" STRETCHABLE METAL HAND SHOWER HOSE

SKU: 948938
SHH1010

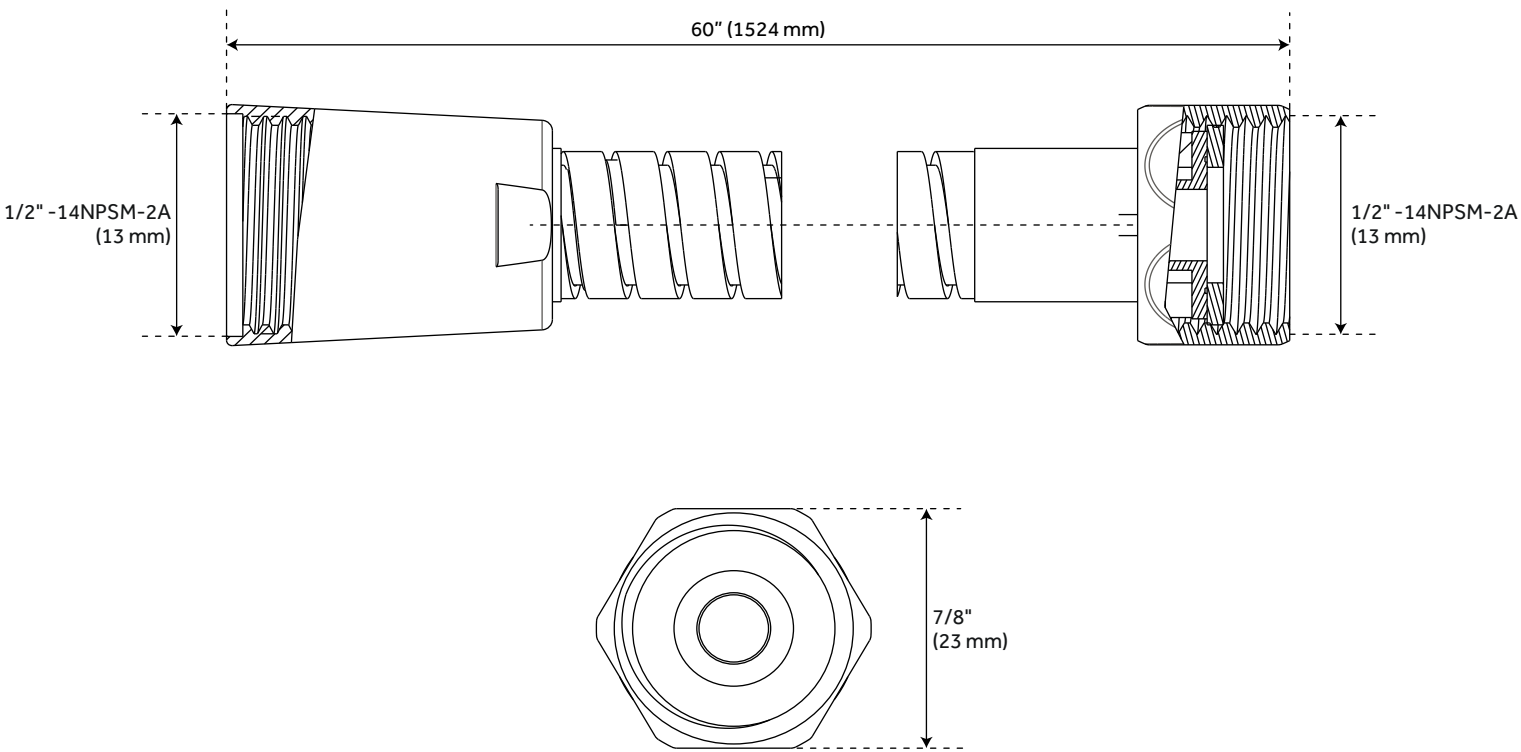

All dimensions and specifications are nominal and may vary. Use actual products for accuracy in critical situations.

MODERN SQUARE WALL-MOUNT SHOWER ARM WITH FLANGE

SKU: 948956
SHRSA120S, SHRSA120SZ, SHRSA180S, SHRSA180Z

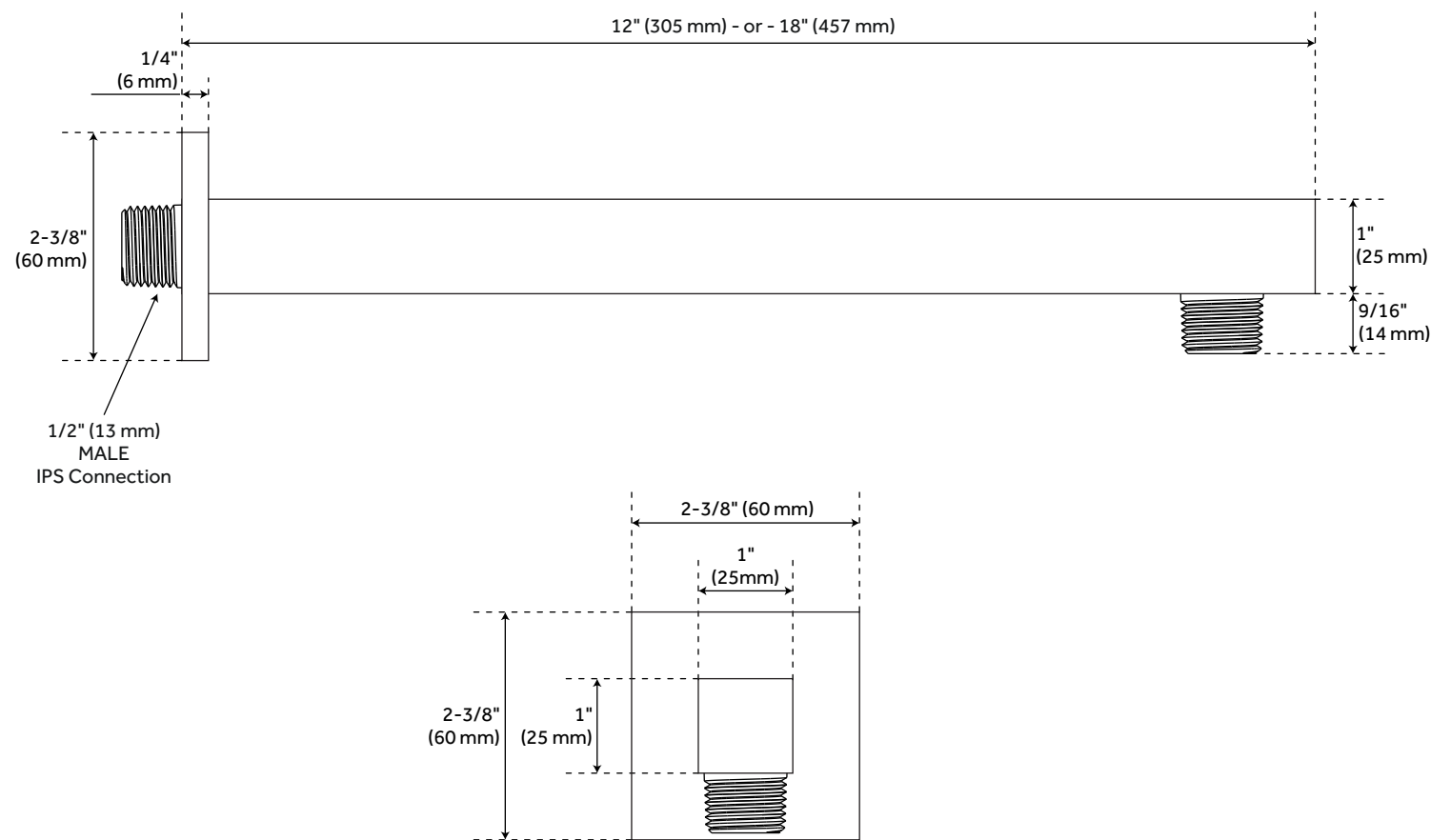

All dimensions and specifications are nominal and may vary. Use actual products for accuracy in critical situations.

3-WAY IN-WALL DIVERTER ROUGH-IN VALVE

SKU: 953056
SH6101, SH6103

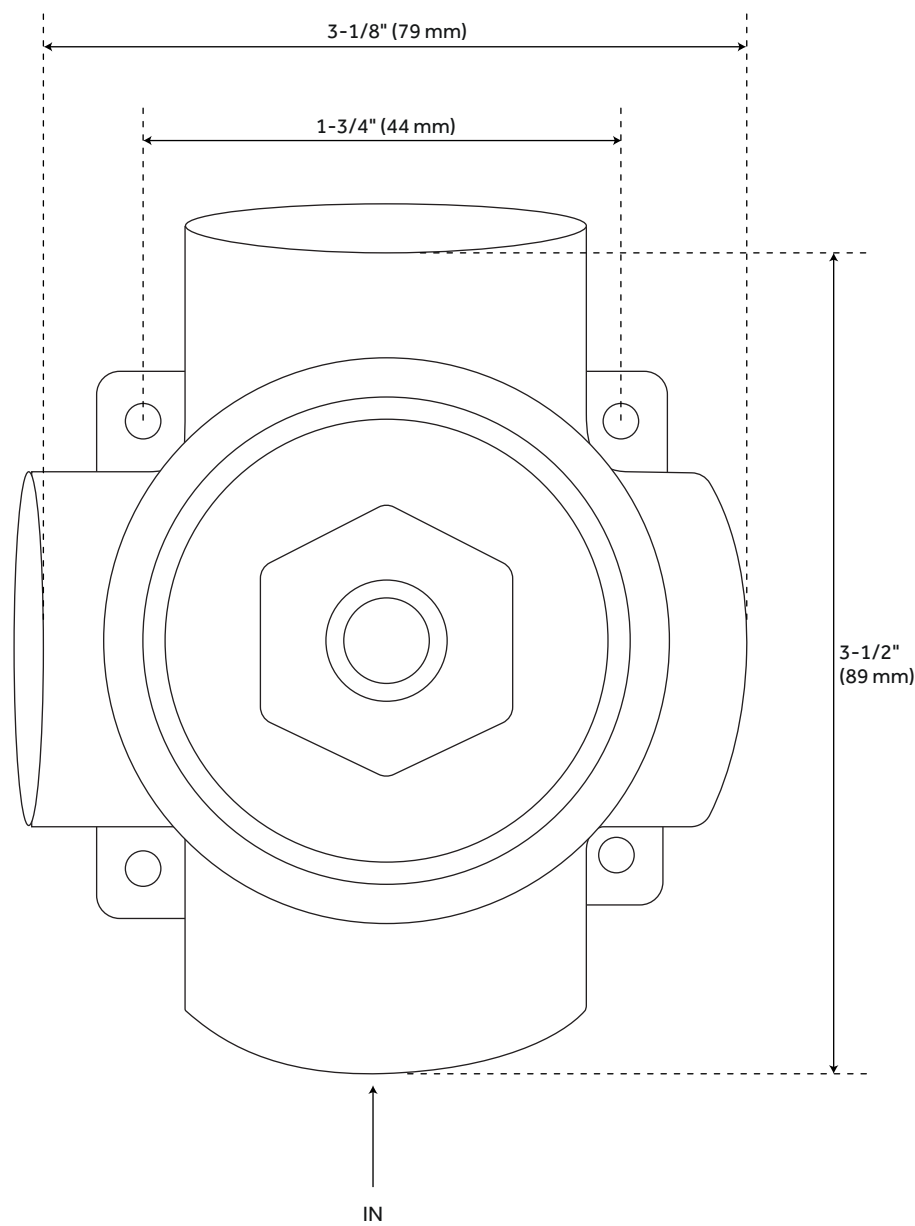

All dimensions and specifications are nominal and may vary. Use actual products for accuracy in critical situations.