



# ANNELLA TUB AND SHOWER SET

## BEFORE YOU BEGIN

We recommend consulting a professional if you are unfamiliar with installing plumbing fixtures. Signature Hardware accepts no liability for any damage to the plumbing, floor, walls, tub, or for personal injury during installation.

Observe all local plumbing and building codes.

Unpack and inspect the item for shipping damage. If any damage is found, contact our Customer Relations team at 1-855-715-1800.

## GETTING STARTED

- Ensure that you have gathered all the required materials that are needed for the installation.
- For the following installation instructions, it is assumed that the wall has been opened and that the existing shower set has been removed.
- Before you begin, the main water supply to your home should be shut off.

## TOOLS AND MATERIALS:



Plumber's Tape\*



Tape Measure\*



Adjustable Wrench\*



Phillips Screwdriver\*



Drill\*



Hex Wrench



Wood Blocking\*



1/2" Test Plug\*

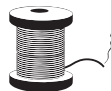

Soldering Kit (for copper pipe)\*

\*not included



# ANNELLA TUB AND SHOWER SET

## STEP 1: VALVE INSTALLATION

1. To prepare for installation, wood blocking should be installed between the two studs where the valve, shower head, and tub spout will mount. The wood blocking will need to be installed 2" behind the finished wall.

**Important:** Take into consideration the thickness of the finished wall materials, such as tile, when calculating measurements.

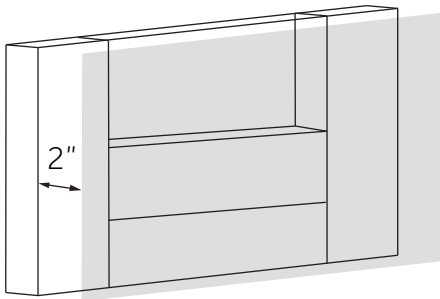

2. Remove the plastic guard from the valve body and secure the valve to the prepared wood blocking using the provided hardware. Ensure that the outlet labeled 'UP' is facing up, and that the valve is level.

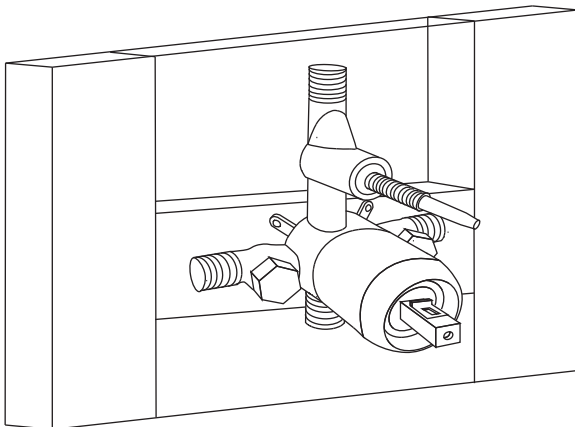

3. Route, assemble, and connect all piping to the shower valve. Make connections appropriately depending upon the type of pipe that is being used. For copper pipe, soldering will be required and should be completed by a licensed plumber. Apply plumber's tape to any threaded connection if applicable.

**Important:** Approximately 2" of copper pipe will need extend beyond the finished wall to mount the tub spout. A male adapter will be needed for mounting the shower arm.

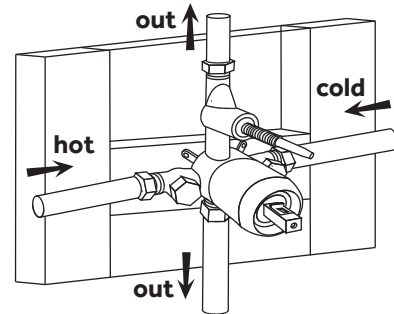

4. Secure the tub and shower pipes to their prepared wood blocking. If the elbow fittings used do not contain mounting tabs, use copper tube straps.

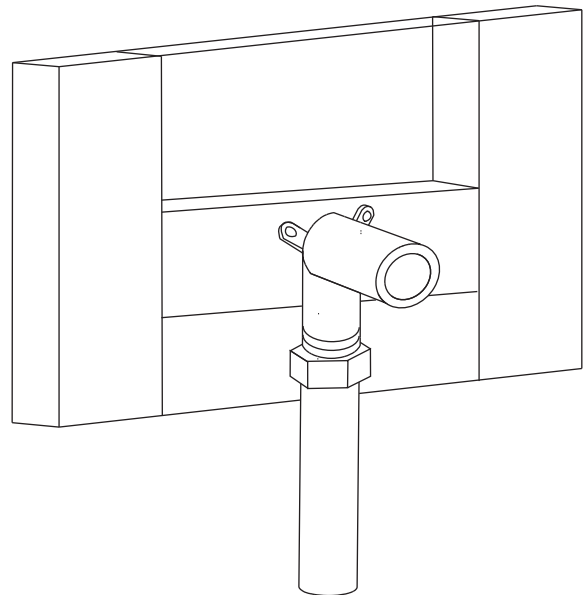



## ANNELLA TUB AND SHOWER SET

5. Once all piping is routed and connections have been made, plug the shower and tub spout outlets using  $\frac{1}{2}$ " test plugs. Turn on the main water supply to your home and water test the installed plumbing. Ensure that there are no leaks, then shut the water off.

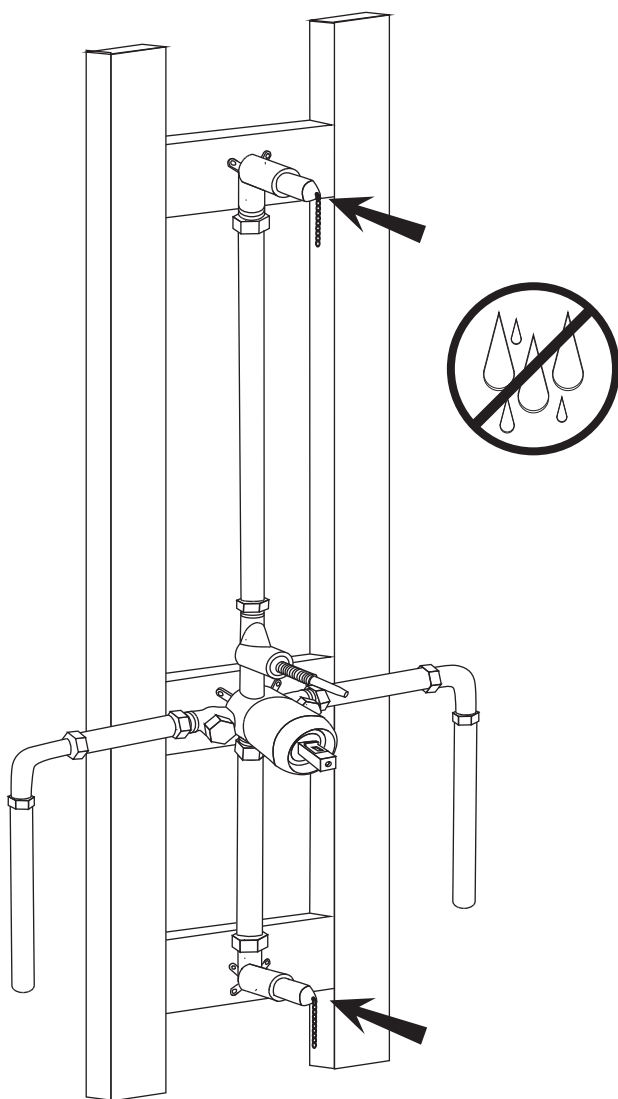

6. Reattach the plastic guard to the shower valve, and complete wall construction. Once the finished wall has been completed, proceed to installing the trim components.

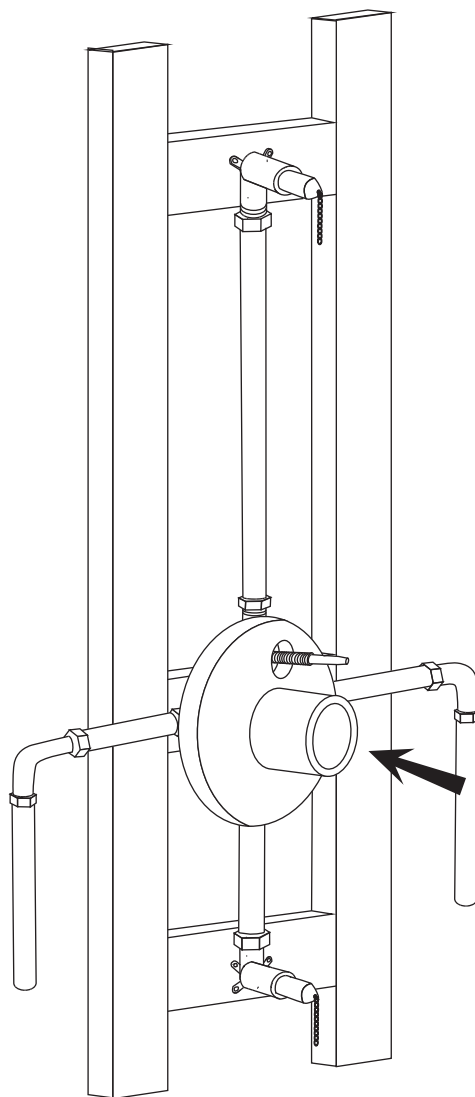



## ANNELLA TUB AND SHOWER SET

### STEP 2: TRIM INSTALLATION

1. Once the finished wall is complete, remove the plastic guard from the valve. If the test plugs have not yet been removed, remove those as well.

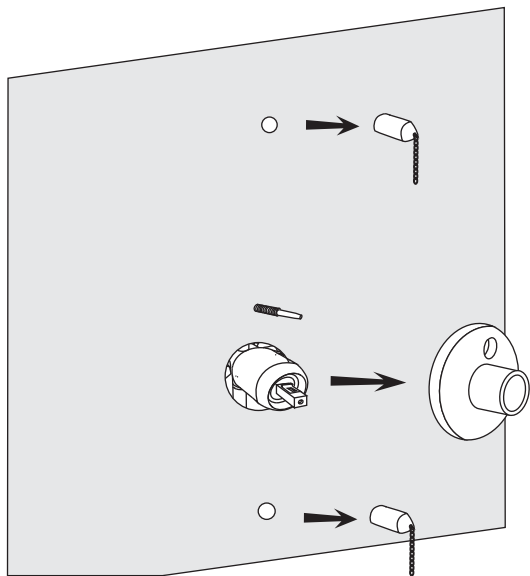

2. Slide the decorative baseplate onto the valve. Slide the diverter's handle base into its hole, then hand tighten onto the valve to secure.

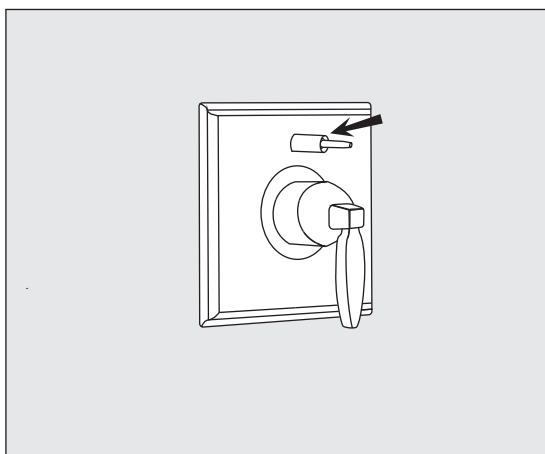

3. Attach the diverter button by threading it onto its mounting post. Attach the temperature control handle by sliding it into position, then secure it by tightening the set screw underneath.

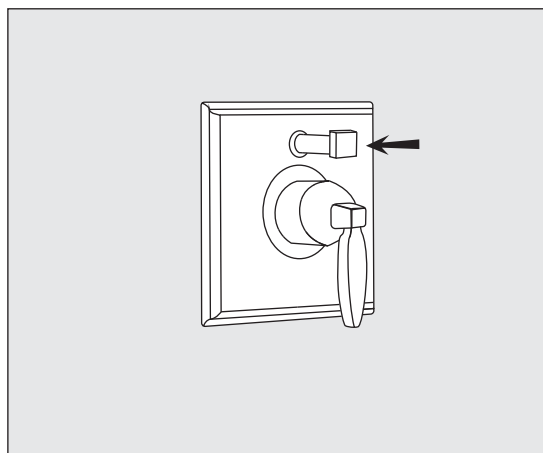

4. Attach the tub spout by sliding it onto the copper supply pipe, then tighten the set screw underneath to secure.

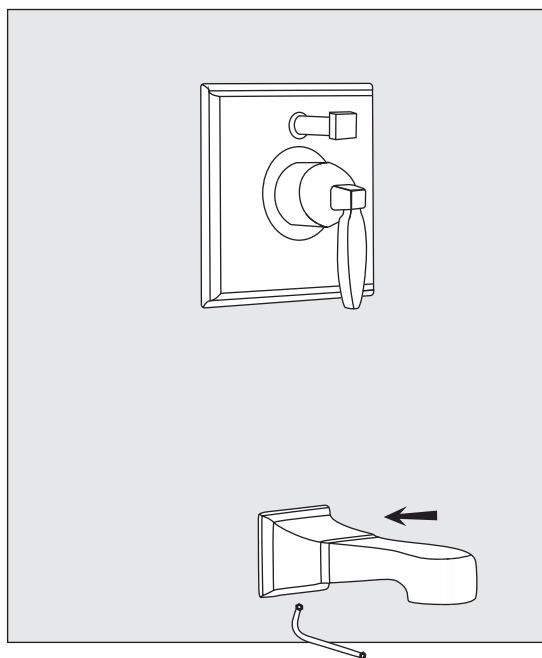



## ANNELLA TUB AND SHOWER SET

5. Attach the shower arm by threading it onto the male adapter. Apply plumber's tape to the threads before attaching.

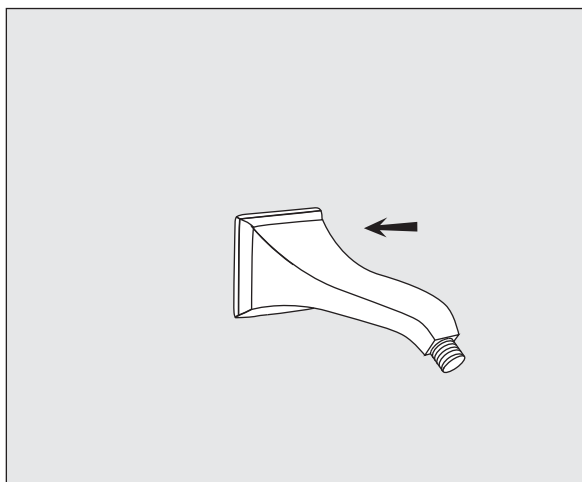

6. Complete the installation by threading the shower head onto the shower arm. Apply plumber's tape to the threads before attaching.

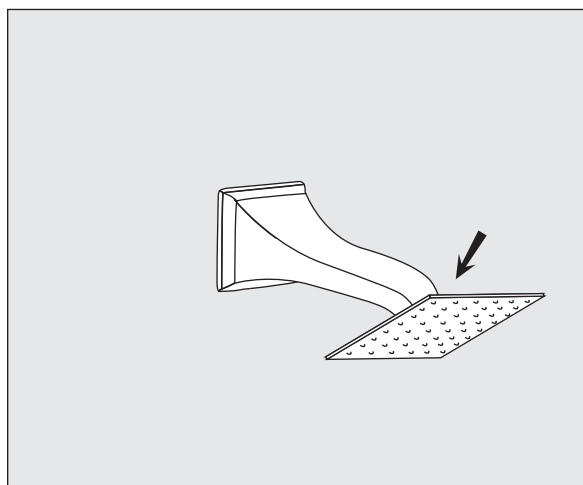

7. Turn the main water supply back on, and test the completed shower system. Ensure that there are no leaks and that all functions are working properly.

