

VOLUME CONTROL ROUGH-IN VALVE

Product Code: SH6040 (3/4" NPT), SH6020 (1/2" NPT)

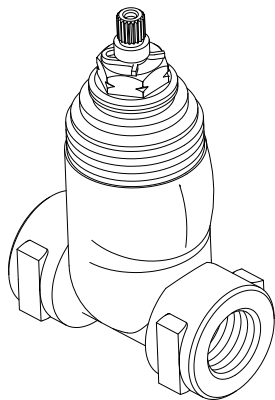

Product Features

- Bronze valve body
- Ceramic cartridge
- Requires volume control trim (sold separately)
- Requires thermostatic valve and trim (sold separately)

Optional Accessories

- SH6020EXT - Extension kit for 1/2" & 3/4" volume control rough-in valve
- SH6040CRT - Replacement 3/4" cartridge
- SH6020CRT - Replacement 1/2" cartridge

Codes and Certifications



- Meets ASME A112.18.1 / CSA B125.1
- Massachusetts Accepted

Part Code	Pressure Differential - psi			
	20 psi	40 psi	60 psi	80 psi
SH6020	6.0 gpm (22.6 L/min)	8.9 gpm (33.6 L/min)	10.8 gpm (41.1 L/min)	12.8 gpm (48.3 L/min)
SH6040	20 psi	40 psi	60 psi	80 psi
	9.9 gpm (37.3 L/min)	14.2 gpm (53.7 L/min)	17.1 gpm (64.8 L/min)	20.1 gpm (76.1 L/min)

Revised: 11/21/25

VOLUME CONTROL ROUGH-IN VALVE

Product Code: SH6040 (3/4" NPT), SH6020 (1/2" NPT)

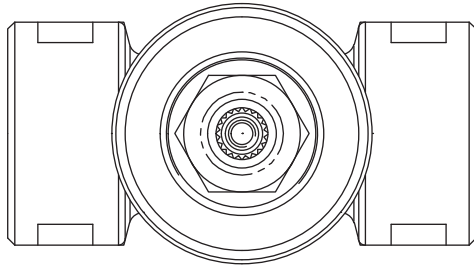

SH6020: 1/2"-14NPT
SH6040: 3/4"-14NPT

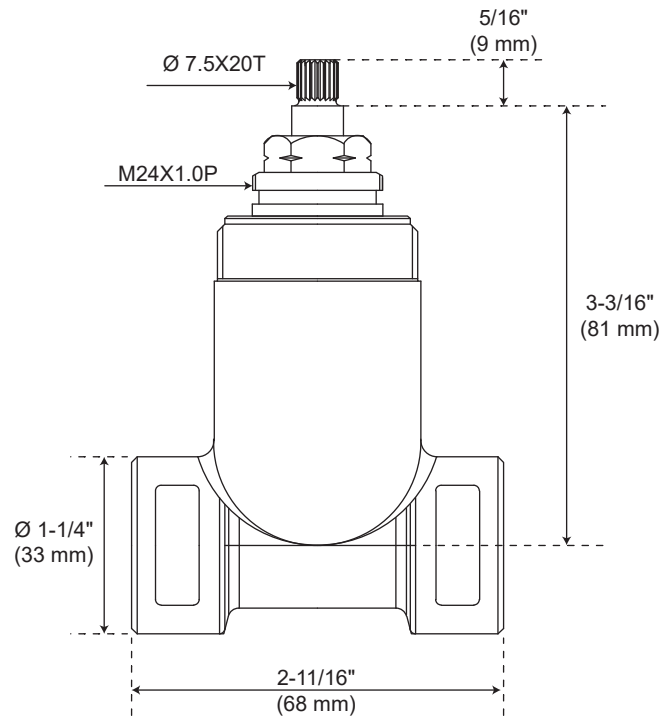
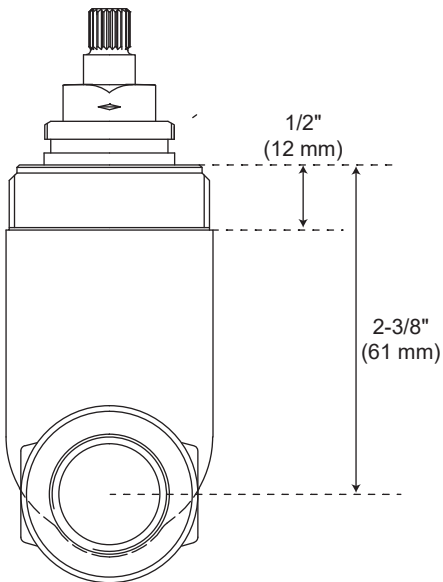

All dimensions and specifications are nominal and may vary. Use actual products for accuracy

Revised: 11/21/25