



IMPORTANT FAUCET INSTALLATION NOTICE

Before using a newly installed faucet, remove the aerator, if applicable. Turn on the water to the faucet and let it flow for 15 seconds. This flushes out sediment in the water line, preventing it from becoming lodged in the faucet valves, which can affect performance and cause damage to the faucet.

FLUSHING WATER LINES

If your faucet has an uneven flow or is dripping, it may be due to a buildup of sediment. Follow these steps to restore normal water flow. If your faucet does not have an aerator, proceed to step 4.

What You'll Need: Open-ended wrench, large bucket, pliers, towel, rag.

1. Place a towel at the base of the faucet and remove the faucet aerator. If using pliers, place a rag around the aerator to protect the finish.

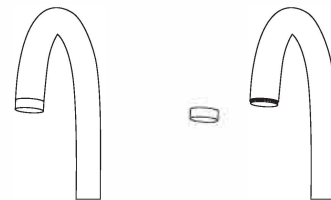

2. Turn on the cold and hot water, letting the faucet run for 10-15 seconds.

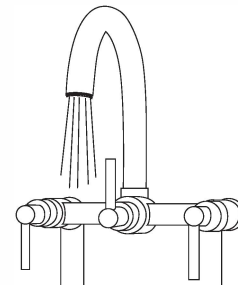

3. Rinse out the aerator, carefully noting the placement of washers inside. Replace the aerator and check water flow. If there is no improvement, continue to Step 4.

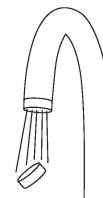

4. Close the shut-off valves or turn off your home's water main, twisting the valves clockwise as far as possible.

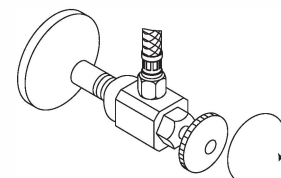



FLUSHING WATER LINES (CONTINUED)

5. Turn on the hot and cold faucet taps to release any pressure and excess water. Turn off.

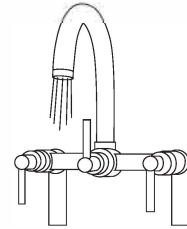

6. With a wrench, remove water lines underneath the faucet, placing the ends in a bucket.

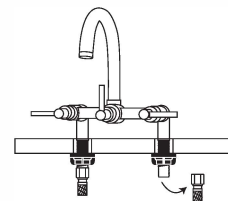

7. Open the shut-off valve or water main and let water flow into the bucket for 15 seconds.

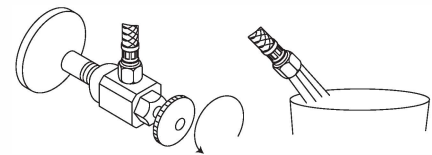

8. Close the shut-off valve or main supply, then reattach the water lines to the faucet.

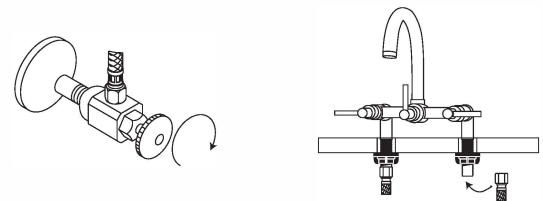

9. Reopen the valves to restore water to the faucet and check for leaks.

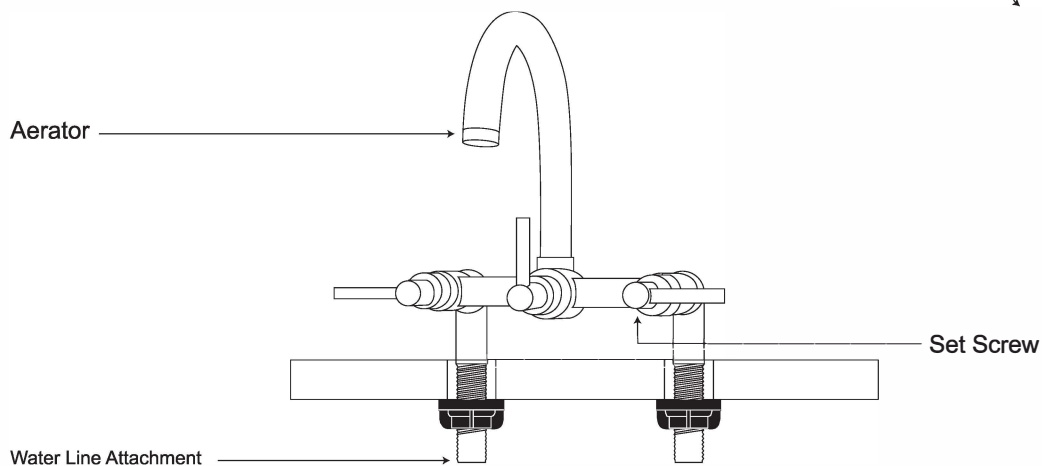
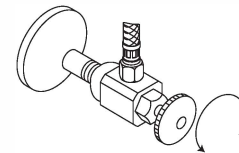



CLEANING A FAUCET CARTRIDGE

What You'll Need: Open-ended wrench, screw driver, small cup or other plastic container, towel.

Note: If there is not a shut-off valve at the faucet, you will need an assistant at the water main.

1. Close the shut-off valves or turn off your home's water main.

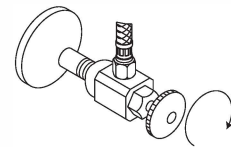

2. Turn on the faucet's hot and cold taps to release excess water and pressure on the fixture. Turn off once excess water is expelled.

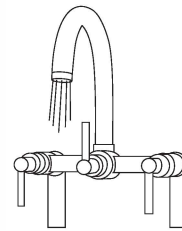

3. Remove the faucet handles by unscrewing the screw or set screw (depending on the style of your faucet).

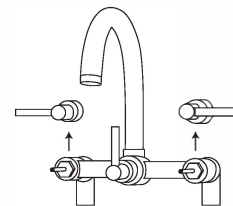

4. Loosen the locknuts and remove the cartridge(s), noting their positions (if reassembled in the wrong position, their handle action will be reversed).

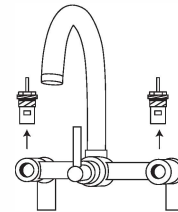

5. Place a small cup or other plastic container upside down over the cartridge cavity. Place a towel behind the faucet to prevent water from spraying out.

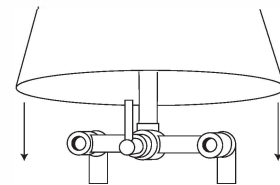

6. Holding the cup in place, turn on the hot water valve and let run for 3-5 seconds. Holding the cup in place, do the same for the cold water. This will dislodge any debris in the water line.

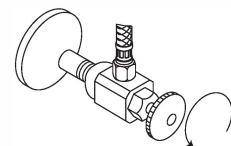



CLEANING A FAUCET CARTRIDGE (CONTINUED)

7. Place the cartridge(s) individually in a bucket of clean water and move each cartridge back and forth while cycling the stem through the operational settings. The handle may need to be temporarily placed on the stem to do this.



8. Reinsert the cartridge(s) in the correct position, then reassemble the trim and handle. Turn on the faucet to test water flow and check for leaks.

