



SKU(s): 905707

# REPRODUCTION NON-MIXING SINK FAUCET

## BEFORE YOU BEGIN

We recommend consulting a professional if you are unfamiliar with installing plumbing fixtures. Signature Hardware accepts no liability for any damage to the faucet, plumbing, sink, counter top, or for personal injury during installation.

Observe all local plumbing and building codes.

Unpack and inspect the faucet for shipping damage. If any damage is found, contact our Customer Relations team at 1-866-855-2284.

## GETTING STARTED

- Ensure that you have gathered all the required materials that are needed for the installation.
- For these instructions, it is assumed that the old faucet has been completely removed and any necessary repairs or modifications to the water supply have been completed.

## TOOLS AND MATERIALS:



Plumbers  
Tape



Thread  
Sealant



Basin  
Wrench



Adjustable  
Wrench



Small  
Bucket



Braided  
Water Lines



# REPRODUCTION NON-MIXING SINK FAUCET

## INSTALLATION

1. Ensure that the water supply below your sink is completely shut off by turning the shutoff valves all the way to the right.

**Tip:** Place a small bucket below your workspace to catch any water that may drip during the installation process.

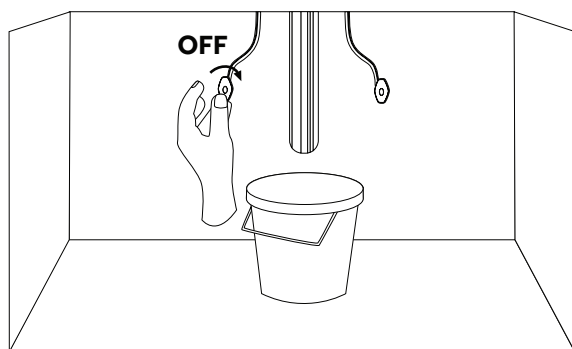

2. Insert the faucet spout labeled as 'hot' into the left-side mounting hole that has been prepared.

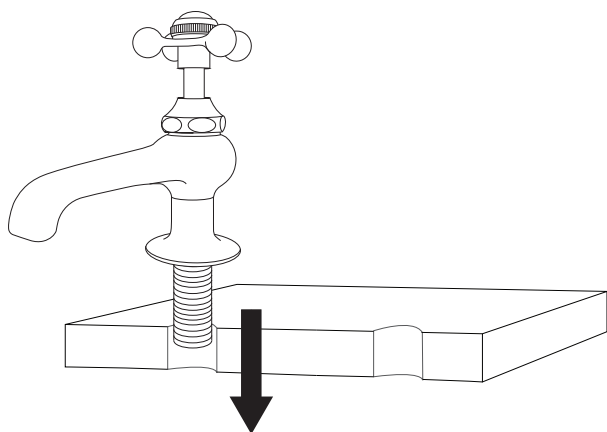

3. From below, slide one of the provided rubber washers onto the threaded shank followed by one of the metal washers. The textured side of the metal washer should face down. Secure the spout to the surface using one of the plastic lock nuts. Hand tighten firmly.

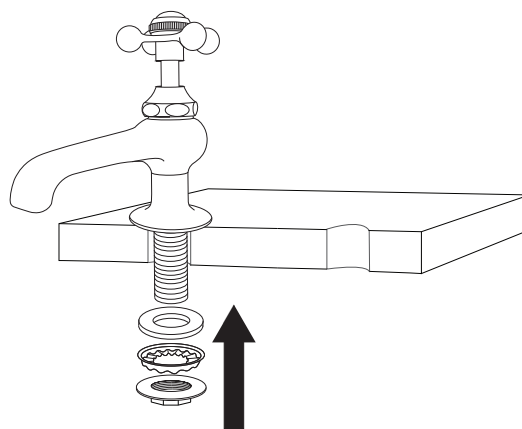

4. Repeat steps 2 and 3 to install the 'cold' spout into the right-side mounting hole that has been prepared.

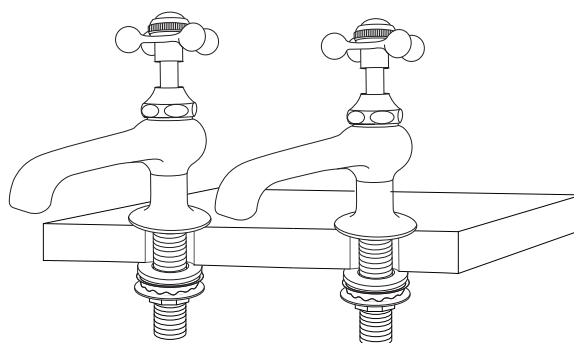



## REPRODUCTION NON-MIXING SINK FAUCET

5. Use braided water lines to connect each spout to the main water supply. Use the provided brass nuts and cone washers to make the connections if needed. Be careful not to overtighten the water lines.

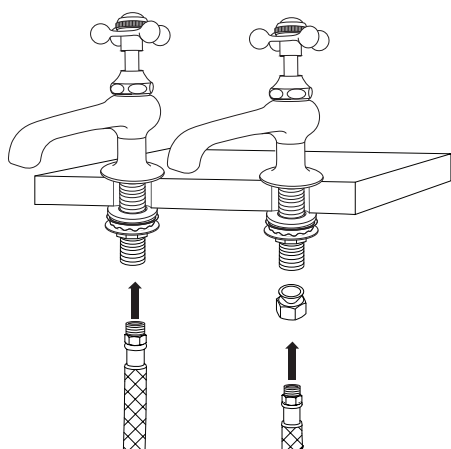

6. Once installation is complete, turn the main water supply back on from underneath your sink. Check for any leaks underneath.

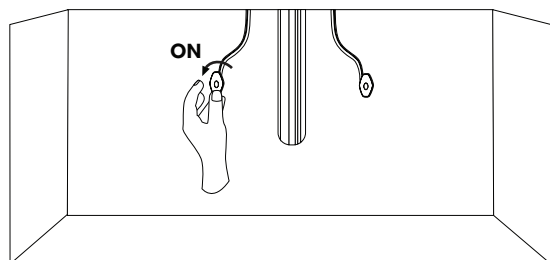

7. Proceed to the drain installation. Once complete, turn the faucet on for approximately 60 seconds to remove any dust or loose sediment from the water lines. Ensure that there are no leaks, and that both hot and cold water are running properly. Turn off once testing is complete.

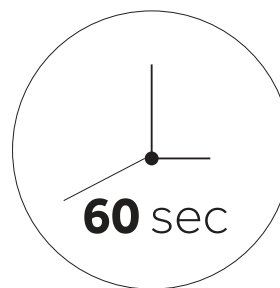



# REPRODUCTION NON-MIXING SINK FAUCET

## DRAIN INSTALLATION

1. Dissassemble the drain assembly and lay the parts aside, in the same order they were removed. See the illustration below as a reference if needed.

Pop-Up Drain Flange

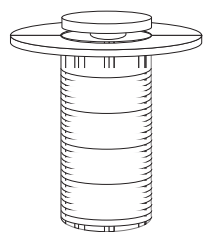

Flat Rubber Gasket



Tapered Rubber Gasket



Plastic Friction Washer



Lock Nut



Tailpiece

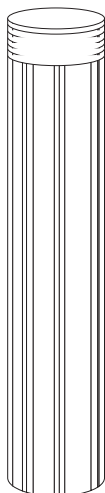

2. Apply plumber's tape to the threading on the tailpiece, then reattach the tail piece to the pop-up drain flange.

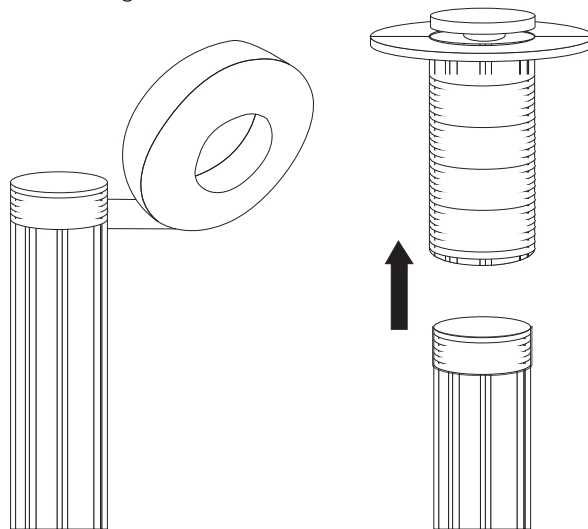

3. Slide the flat rubber gasket up the tailpiece until it meets the lip of the pop-up drain flange.

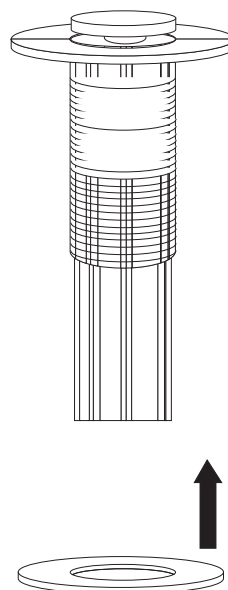



## REPRODUCTION NON-MIXING SINK FAUCET

4. Insert the drain flange and tailpiece through the top of your sink's drain hole.

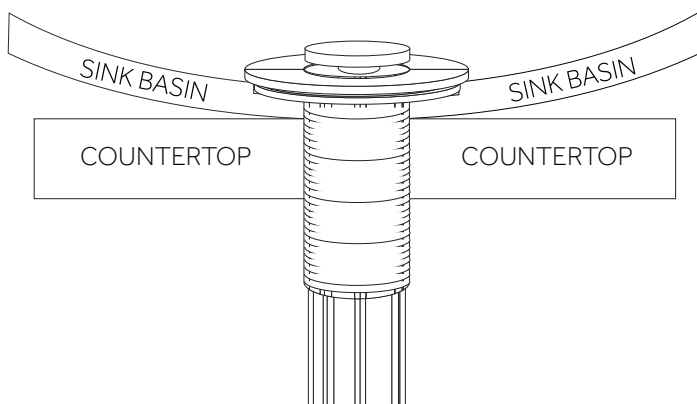

5. From under your counter, slide the tapered rubber gasket followed by the plastic friction washer onto the tailpiece until they meet your sink or countertop. Be sure that the tapered side of the rubber washer is facing up.

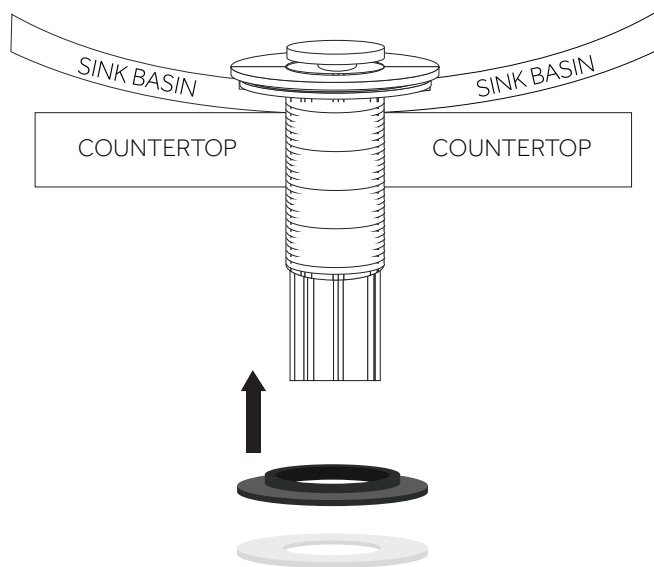

6. Thread the lock nut onto the drain flange. Hand tighten until secure, then finish tightening with a basin wrench once the drain is properly aligned.

**Important:** Be careful not to overtighten, which could crack a porcelain sink or stone countertop.

